



**MOTION TECHNOLOGIES
PTY LTD**

PM BRUSH DC GEAR MOTOR





PM DC GearMotor

25JA3K SERIES

◆ Indications of the model

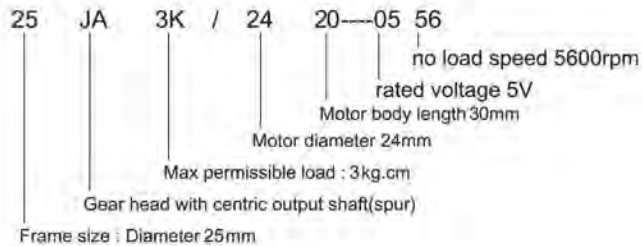

◆ Gearhead Specifications

Number of gear trains	3	4	5	6	7
Reduction ratio	11	23 27	52 60 69 81	113 132 153 178 210	250 290 350 390 450
Rated permissible load kg.cm	1	1	2	3	3
Max permissible load in a short time kg.cm	2	2	4	6	6
Efficiency %	68	60	53	46	41
Radial play of shaft mm	≤ 0.1	≤ 0.1	≤ 0.1	≤ 0.1	≤ 0.1
Thrust play of shaft mm	≤ 0.35	≤ 0.35	≤ 0.35	≤ 0.35	≤ 0.35

◆ Gearhead Dimensions

Reduction ratio	I	L
10~30	21	36
50~90	23	38
100~200	25	40
250~700	27	42

Specifications of initial pinion

Module	0.4
No.of teeth	10
Pressure angle	20°
Outside diameter	$\phi 5.04^{+0.02}_{-0.02}$
Hole diameter	$\phi 5.04^{+0.02}_{+0.006}$
Range	Suitable of all range

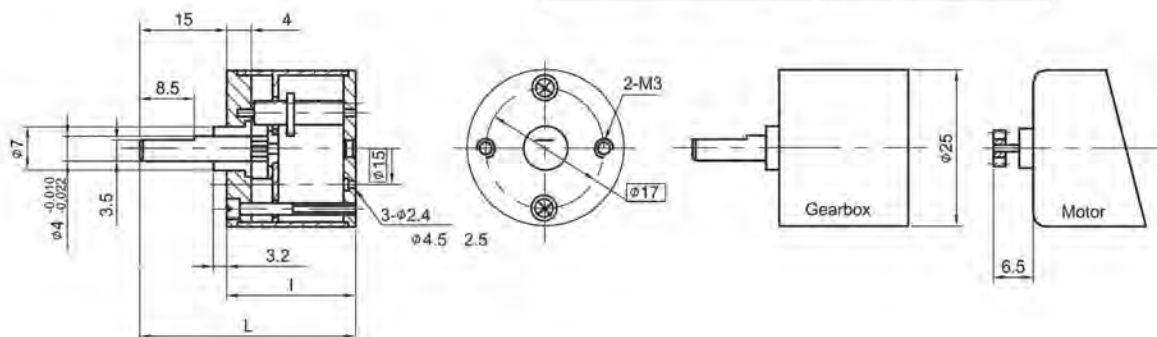

PM DC SPUR GEARMOTOR

25JA3K/2420

◆ Dimensions

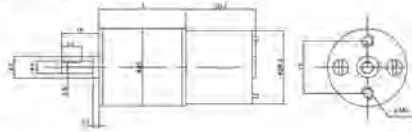

◆ Motor Technical Data

TYPE	Rated voltage VDC	No-load speed r/min	No-load current mA	Rated speed r/min	Rated torque g.cm	Output power W	Rated current mA	Stall torque g.cm	Stall current A
2420-0556	5	5600	55	4600	4.5	0.2	120	25	450
2420-0667	6	6700	65	5400	7	0.4	130	36	530
2420-1252	12	5200	40	3900	6.1	0.24	70	24	260

◆ Gearmotor Technical Data

25JA3K/2420-0556

Reduction ratio	11	23	27	52	60	69	81	113	132	153	178	210	250	290	350	390	450
Number of gear trains	3	4	4	5	5	5	5	6	6	6	6	6	7	7	7	7	7
Length(L) mm	21	21	21	23	23	23	23	25	25	25	25	25	27	27	27	27	27
No-load speed r/min	509	243	207	108	93	81	69	61	42	37	31	27	22	19	16	14	12
Rated speed r/min	418	200	170	88	77	67	57	41	35	30	26	22	18	16	13	12	10
Rated torque kg.cm	0.03	0.06	0.07	0.12	0.14	0.16	0.19	0.23	0.27	0.32	0.37	0.43	0.46	0.30	0.64	0.72	0.83
Direction of rotation	CW	CCW	CCW	CW	CW	CW	CW	CCW	CCW	CCW	CCW	CCW	CW	CW	CW	CW	CW

25JA3K/2420-0667

Reduction ratio	11	23	27	52	60	69	81	113	132	153	178	210	250	290	350	390	450
Number of gear trains	3	4	4	5	5	5	5	6	6	6	6	6	7	7	7	7	7
Length(L) mm	21	21	21	23	23	23	23	25	25	25	25	25	27	27	27	27	27
No-load speed r/min	609	291	248	129	112	97	83	59	51	44	38	32	27	23	20	17	15
Rated speed r/min	491	235	200	104	90	78	67	48	41	35	30	26	22	19	16	14	12
Rated torque kg.cm	0.05	0.10	0.11	0.19	0.22	0.25	0.30	0.36	0.42	0.49	0.57	0.68	0.72	0.83	0.97	1.12	1.29
Direction of rotation	CW	CCW	CCW	CW	CW	CW	CW	CCW	CCW	CCW	CCW	CCW	CW	CW	CW	CW	CW

25JA3K/2420-1252

Reduction ratio	11	23	27	52	60	69	81	113	132	153	178	210	250	290	350	390	450
Number of gear trains	3	4	4	5	5	5	5	6	6	6	6	6	7	7	7	7	7
Length(L) mm	21	21	21	23	23	23	23	25	25	25	25	25	27	27	27	27	27
No-load speed r/min	473	226	192	100	87	75	64	46	39	34	29	25	21	18	15	13	11
Rated speed r/min	354	169	144	75	65	56	48	34	29	25	22	18	16	13	11	10	8
Rated torque kg.cm	0.04	0.08	0.10	0.17	0.19	0.22	0.26	0.32	0.37	0.43	0.50	0.59	0.62	0.72	0.85	0.97	1.12
Direction of rotation	CW	CCW	CCW	CW	CW	CW	CW	CCW	CCW	CCW	CCW	CCW	CW	CW	CW	CW	CW

PM DC GearMotor

37JB6K SERIES

◆ Indications of the model

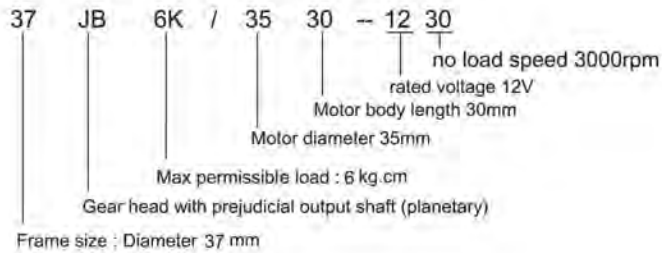

◆ Gearhead Specifications

Number of gear trains	2	3	4	5	6	7
Reduction ratio	6 10	18 30	50 60 75 100	120 150 180 200 250 300	350 400 450 500 600 750 1000	1500 3000
Rated permissible load kg.cm	1	2	4	6	6	6
Max permissible load in a short time kg.cm	3	6	12	18	18	18
Efficiency %	81	73	66	59	53	48
Radial play of shaft mm	≤ 0.1	≤ 0.1	≤ 0.1	≤ 0.1	≤ 0.1	≤ 0.1
Thrust play of shaft mm	≤ 0.35	≤ 0.35	≤ 0.35	≤ 0.35	≤ 0.35	≤ 0.35

◆ Gearhead Dimensions

Reduction ratio	J	L
6~10	19	40
18~30	21.5	42.5
50~100	24	45
120~300	26.5	47.5
350~1000	29	50
1500~3000	31.5	52.5

Specifications of initial pinion

Module	0.5
No. of teeth	10
Pressure angle	20°
Outside diameter	$\phi 6.32^{+0.02}_{-0.02}$
Hole diameter	$\phi 2^{+0.02}_{-0.006}$
Range	Suitable of all range

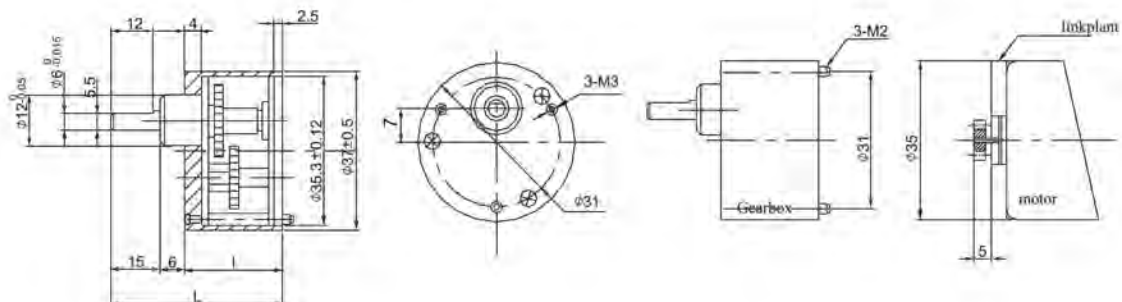

PM DC SPUR GEARMOTOR

37JB6K/3324

◆ Dimensions



◆ Motor Technical Data

TYPE	Rated voltage VDC	No-load speed r/min	No-load current mA	Rated speed r/min	Rated torque g.cm	Output power W	Rated current mA	Stall torque g.cm	Stall current A
3324-0630	6	2900	50	2200	25	0.56	170	100	0.46
3324-1230	12	3000	45	2300	25	0.59	90	100	0.26
3324-2430	24	3000	35	2300	25	0.59	70	100	0.14

◆ Gearmotor Technical Data

37JB6K/3324-0630

Reduction ratio	6	10	18	30	50	75	100	150	200	250	300	400	500	750	1000
Number of gear trains	2	2	3	3	4	4	4	5	5	5	5	6	6	6	6
Length(L) mm	19	19	21.5	21.5	24	24	24	26.5	26.5	26.5	26.5	29	29	29	29
No-load speed r/min	483	290	161	96	58	38	29	19	14	11	9	7	5.5	3.5	3
Rated speed r/min	366	230	122	73	44	29	22	14	11	8	7	5.5	4.5	3	3
Rated torque kg.cm	0.1	0.2	0.3	0.5	0.8	1.2	1.6	2.2	2.9	3.7	4.4	5.3	6	6	6
Max permissible load in a short time kg.cm	3	3	6	6	12	12	12	18	18	18	18	18	18	18	18
Direction of rotation	CCW	CCW	CW	CW	CCW	CCW	CCW	CW	CW	CW	CW	CCW	CCW	CCW	CCW

37JB6K/3324-1230

Reduction ratio	6	10	18	30	50	75	100	150	200	250	300	400	500	750	1000
Number of gear trains	2	2	3	3	4	4	4	5	5	5	5	6	6	6	6
Length(L) mm	19	19	21.5	21.5	24	24	24	26.5	26.5	26.5	26.5	29	29	29	29
No-load speed r/min	500	300	167	100	60	40	30	20	15	12	10	7.5	6	4	3
Rated speed r/min	383	230	127	76	46	30	23	15	11	9	7.5	6	4.5	3	2.5
Rated torque kg.cm	0.1	0.2	0.3	0.5	0.8	1.2	1.6	2.2	2.9	3.7	4.4	5.3	6	6	6
Max permissible load in a short time kg.cm	3	3	6	6	12	12	12	18	18	18	18	18	18	18	18
Direction of rotation	CCW	CCW	CW	CW	CCW	CCW	CCW	CW	CW	CW	CW	CCW	CCW	CCW	CCW

PM DC SPUR GEARMOTOR

80JB80K/73110

◆ Dimensions

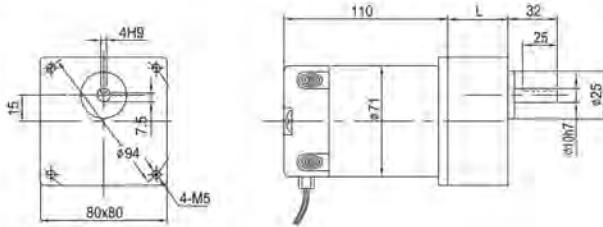

◆ Motor Technical Data

TYPE	Rated voltage VDC	No-load speed r/min	No-load current A	Rated speed r/min	Rated torque kg.cm	Output power W	Rated current A	Stall torque kg.cm	Stall current A
73110-2420	24	2000	0.40	1600	2.0	33	2.4	10	9.5
73110-2430	24	3000	0.58	2400	2.4	59	3.5	12	14

◆ Gearmotor Technical Data

80JB80K/73110-2420(33W)

Reduction ratio	3	5	7.5	12.5	15	25	30	50	75	100	120	150
Number of gear trains	2	2	2	2	2	3	3	3	4	4	4	4
Length(L) mm	32	32	32	32	32	44	44	44	44	44	44	44
No-load speed r/min	667	400	267	160	133	80	67	40	27	20	17	13
Rated speed r/min	533	320	213	128	106	64	53	32	21	16	14	11
Rated torque kg.cm	5	8	12	20	24	36	44	72	80	80	80	80
Max permissible load in a short time kg.cm	20	40	40	40	40	80	80	120	120	120	120	120
Direction of rotation	CCW	CCW	CCW	CCW	CCW	CW	CW	CW	CCW	CCW	CCW	CCW

80JB80K/73110-2430(59W)

Reduction ratio	3	5	7.5	12.5	15	25	30	50	75
Number of gear trains	2	2	2	2	2	3	3	3	4
Length(L) mm	32	32	32	32	32	44	44	44	44
No-load speed r/min	1000	600	400	240	200	120	100	60	40
Rated speed r/min	800	480	320	192	160	96	80	48	34
Rated torque kg.cm	6	17	14	24	29	44	52	80	80
Max permissible load in a short time kg.cm	20	40	40	40	40	80	80	120	120
Direction of rotation	CCW	CCW	CCW	CCW	CCW	CW	CW	CW	CCW

PM DC SPUR GEARMOTOR

90JB200K/83125

◆ Dimensions

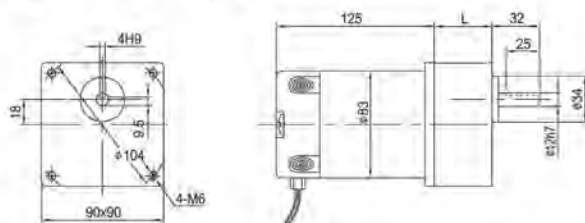

◆ Motor Technical Data

TYPE	Rated voltage VDC	No-load speed r/min	No-load current A	Rated speed r/min	Rated torque kg.cm	Output power W	Rated current A	Stall torque kg.cm	Stall current A
83125-2420	24	2000	0.80	1700	2.4	42	3.5	16	17
83125-2430	24	3000	0.90	2500	3	77	4.6	18	20

◆ Gearmotor Technical Data

90JB200K/83125-2420(42W)

Reduction ratio	3	5	7.5	12.5	15	25	30	50	75	100	120	150
Number of gear trains	2	2	2	2	2	3	3	3	3	4	4	4
Length(L) mm	45	45	45	45	45	60	60	60	60	60	60	60
Dia.of shaft (φ) mm	12	12	12	12	12	12	12	12	12	12	12	12
No-load speed r/min	667	400	267	160	133	80	67	40	27	20	16	13
Rated speed r/min	567	340	227	136	113	68	57	34	23	17	14	12
Rated torque kg.cm	6	10	14	24	29	44	52	87	131	158	190	200
Max.permissible load in a short time kg.cm	45	65	65	65	65	90	90	250	250	250	250	250
Direction of rotation	CCW	CCW	CCW	CCW	CCW	CW	CW	CW	CW	CCW	CCW	CCW

90JB200K/83125-2430(77W)

Reduction ratio	3	5	7.5	12.5	15	25	30	50	75	100
Number of gear trains	2	2	2	2	2	3	3	3	3	4
Length(L) mm	45	45	45	45	45	60	60	60	60	60
Dia.of shaft (φ) mm	12	12	12	12	12	12	12	12	12	12
No-load speed r/min	1000	600	400	240	200	120	100	60	40	30
Rated speed r/min	833	500	333	200	167	100	83	50	35	27
Rated torque kg.cm	8	12	18	30	36	55	66	109	164	198
Max.permissible load in a short time kg.cm	45	120	120	120	120	170	170	250	250	250
Direction of rotation	CCW	CCW	CCW	CCW	CCW	CW	CW	CW	CW	CCW

PM DC WORM GEARMOTOR

90JWG200K/83125

◆ Dimensions

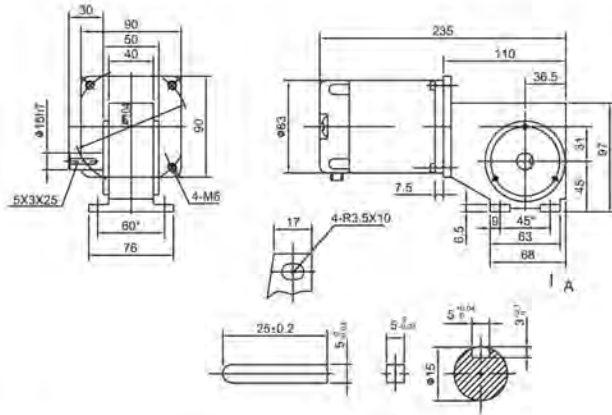

◆ Motor Technical Data

TYPE	Rated voltage VDC	No-load speed r/min	No-load current A	Rated speed r/min	Rated torque kg.cm	Output power W	Rated current A	Stall torque kg.cm	Stall current A
83125-2420	24	2000	0.80	1700	2.4	42	3.5	16	17
83125-2430	24	3000	0.90	2500	3	77	4.6	18	20

◆ Gearmotor Technical Data

90JWG200K/83125-2420(42W)

Reduction ratio	50	40	32	25	16	12.5
No-load speed r/min	40	50	62	80	125	160
Rated speed r/min	30	37	46	60	93	120
Rated torque kg.cm	63	50	40	31	14	11

90JWG200K/83125-2430(77W)

Reduction ratio	50	40	32	25	16	12.5
No-load speed r/min	60	75	93	120	187	240
Rated speed r/min	46	57	71	92	143	184
Rated torque kg.cm	80	64	51	40	18	14

PM DC PLANETARY GEARMOTOR

24JX5K/2430

◆ Dimensions

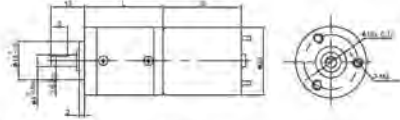

◆ Motor Technical Data

TYPE	Rated voltage VDC	No-load speed r/min	No-load current mA	Rated speed r/min	Rated torque g.cm	Output power W	Rated current mA	Stall torque g.cm	Stall current A
2430-1230	12	3000	40	2400	20	0.5	90	100	0.3
2430-1245	12	4500	60	3600	25	0.9	170	125	0.5
2430-1260	12	6000	70	4800	30	1.5	240	150	1.0

◆ Gearmotor Technical Data

24JX5K/2430-1230

Reduction ratio	4	5	14	19	27	51	71	100	139	189	265	369	516	720
Number of gear trains	2	2	3	3	3	4	4	4	54	5	5	5	5	5
Length(L) mm	25	25	25	25	25	30	30	30	30	39	39	39	39	39
No-load speed r/min	750	600	214	157	111	58	42	30	21	15	11	8	5	4
Rated speed r/min	600	480	171	126	88	47	34	24	17	12	9	6	4	3.6
Rated torque kg.cm	0.07	0.09	0.2	0.3	0.4	0.6	0.9	1.3	1.8	2.1	2.9	4.0	5.0	5.0
Max. permissible load in a short time kg.cm	3	3	6	6	6	8	8	8	8	12	12	12	12	12
Direction of rotation	CCW	CCW	CW	CW	CW	CCW	CCW	CCW	CCW	CW	CW	CW	CW	CW

24JX5K/2430-1245

Reduction ratio	4	5	14	19	27	51	71	100	139	189	265	369	516	720
Number of gear trains	2	2	3	3	3	4	4	4	4	5	5	5	5	5
Length(L) mm	25	25	25	25	25	30	30	30	30	39	39	39	39	39
No-load speed r/min	1125	900	321	236	166	88	63	45	32	23	17	12	8	6
Rated speed r/min	900	720	257	189	133	70	50	36	26	19	13	10	7	5.6
Rated torque kg.cm	0.09	0.1	0.2	0.3	0.5	0.8	1.1	1.6	2.2	2.6	3.6	5.0	5.0	5.0
Max. permissible load in a short time kg.cm	3	3	6	6	6	8	8	8	8	12	12	12	12	12
Direction of rotation	CCW	CCW	CW	CW	CW	CCW	CCW	CCW	CCW	CW	CW	CW	CW	CW

24JX5K/2430-1260

Reduction ratio	4	5	14	19	27	51	71	100	139	189	265	369	516	720
Number of gear trains	2	2	3	3	3	4	4	4	4	5	5	5	5	5
Length(L) mm	25	25	25	25	25	30	30	30	30	39	39	39	39	39
No-load speed r/min	1500	1200	428	315	222	117	84	60	43	31	22	16	11	8
Rated speed r/min	1200	960	342	252	177	94	67	48	34	25	18	13	8	7
Rated torque kg.cm	0.1	0.1	0.3	0.4	0.6	1.0	1.3	1.9	2.7	3.1	4.3	5.0	5.0	5.0
Max. permissible load in a short time kg.cm	3	3	6	6	6	8	8	8	8	12	12	12	12	12
Direction of rotation	CCW	CCW	CW	CW	CW	CCW	CCW	CCW	CCW	CW	CW	CW	CW	CW

PM DC PLANETARY GEARMOTOR

28JX10K/2838

◆ Dimensions



◆ Motor Technical Data

TYPE	Rated voltage VDC	No-load speed r/min	No-load current mA	Rated speed r/min	Rated torque g.cm	Output power W	Rated current mA	Stall torque g.cm	Stall current A
2838-1230	12	3000	60	2500	55	1.4	220	320	1.0
2838-1240	12	4000	70	3000	70	2.1	320	260	1.0

◆ Gearmotor Technical Data

28JX10K/2838-1230

Reduction ratio	4	5	14	19	27	51	71	100	139	189	265	369	516	720
Number of gear trains	2	2	3	3	3	4	4	4	4	5	5	5	5	5
Length(L) mm	38	38	38	38	38	44	44	44	44	50	50	50	50	50
No-load speed r/min	750	600	214	157	111	58	42	30	21	15	11	8	6	4
Rated speed r/min	625	500	178	131	92	49	35	25	18	13	9	6	5	3
Rated torque kg.cm	0.1	0.2	0.5	0.7	1.1	1.8	2.5	3.6	4.9	5.7	8.0	10	10	10
Max permissible load in a short time kg.cm	5	5	10	10	10	20	20	20	20	30	30	30	30	30
Direction of rotation	CCW	CCW	CW	CW	CW	CCW	CCW	CCW	CCW	CW	CW	CW	CW	CW

28JX10K/2838-1240

Reduction ratio	4	5	14	19	27	51	71	100	139	189	265	369	516	720
Number of gear trains	2	2	3	3	3	4	4	4	4	5	5	5	5	5
Length(L) mm	38	38	38	38	38	44	44	44	44	50	50	50	50	50
No-load speed r/min	1000	800	285	210	148	78	56	40	28	21	15	10	7	5
Rated speed r/min	750	600	214	157	111	58	42	30	21	15	11	8	6	4
Rated torque kg.cm	0.2	0.3	0.7	0.9	1.3	2.3	3.2	4.5	6.3	7.2	10	10	10	10
Max permissible load in a short time kg.cm	5	5	10	10	10	20	20	20	20	30	30	30	30	30
Direction of rotation	CCW	CCW	CW	CW	CW	CCW	CCW	CCW	CCW	CW	CW	CW	CW	CW

PM DC PLANETARY GEARMOTOR

36JX10K/3540

◆ Dimensions

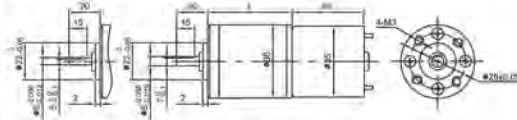

◆ Motor Technical Data

TYPE	Rated voltage VDC	No-load speed r/min	No-load current mA	Rated speed r/min	Rated torque g.cm	Output power W	Rated current mA	Stall torque g.cm	Stall current A
3540-1230	12	3000	90	2300	90	2.1	400	385	0.8
3540-1240	12	4000	100	3200	100	3.3	550	500	2.1
3540-1250	12	5000	110	4300	80	3.5	600	570	2.2
3540-2430	24	3000	50	2300	90	2.1	210	385	1.5
3540-2440	24	4000	55	3000	100	3.1	230	400	0.7
3540-2450	24	5000	60	4100	100	4.2	380	555	2.0

◆ Gearmotor Technical Data

36JX10K/3540-1230

Reduction ratio	4	5	14	19	27	51	71	100	139	189	264	369
Number of gear trains	2	2	3	3	3	4	4	4	4	5	5	5
Length(L) mm	35.5	35.5	35.5	35.5	35.5	41.5	41.5	41.5	41.5	47.5	47.5	47.5
No-load speed r/min	750	600	214	157	111	59	42	30	21	16	11	8
Rated speed r/min	575	460	164	121	85	45	32	23	16	12	9	6
Rated torque kg.cm	0.3	0.36	0.9	1.2	1.7	3.0	4.1	5.8	8.1	9.3	10	10
Max.permissible load in a short time kg.cm	5	5	10	10	10	20	20	20	20	30	30	30
Direction of rotation	CCW	CCW	CW	CW	CW	CCW	CCW	CCW	CCW	CW	CW	CW

36JX10K/3540-1240

Reduction ratio	4	5	14	19	27	51	71	100	139	189	264	369
Number of gear trains	2	2	3	3	3	4	4	4	4	5	5	5
Length(L) mm	35.5	35.5	35.5	35.5	35.5	41.5	41.5	41.5	41.5	47.5	47.5	47.5
No-load speed r/min	1000	800	285	210	148	78	56	40	29	21	15	11
Rated speed r/min	800	640	228	168	118	63	45	32	23	17	12	8
Rated torque kg.cm	0.3	0.4	1.0	1.4	1.9	3.3	4.6	6.5	9.0	10	10	10
Max.permissible load in a short time kg.cm	5	5	10	10	10	20	20	20	20	30	30	30
Direction of rotation	CCW	CCW	CW	CW	CW	CCW	CCW	CCW	CCW	CW	CW	CW

36JX10K/3540-1250

Reduction ratio	4	5	14	19	27	51	71	100	139	189	264	369
Number of gear trains	2	2	3	3	3	4	4	4	4	5	5	5
Length(L) mm	35.5	35.5	35.5	35.5	35.5	41.5	41.5	41.5	41.5	47.5	47.5	47.5
No-load speed r/min	1250	1000	357	263	189	98	70	50	36	26	19	13
Rated speed r/min	1075	860	307	226	159	84	60	43	31	23	16	11
Rated torque kg.cm	0.2	0.3	0.8	1.1	1.5	2.6	3.7	5.2	7.2	8.2	10	10
Max.permissible load in a short time kg.cm	5	5	10	10	10	20	20	20	20	30	30	30
Direction of rotation	CCW	CCW	CW	CW	CW	CCW	CCW	CCW	CCW	CW	CW	CW

PM DC PLANETARY GEARMOTOR

36JX10K/3650

◆ Dimensions

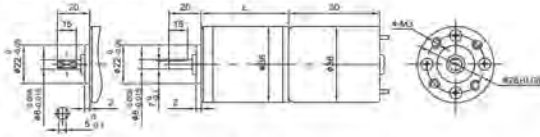

◆ Motor Technical Data

TYPE	Rated voltage VDC	No-load speed r/min	No-load current mA	Rated speed r/min	Rated torque g.cm	Output power W	Rated current A	Stall torque g.cm	Stall current A
3650-2430	24	3000	80	2500	100	2.5	0.30	600	1.4
3650-2436	24	3600	100	3000	110	3.4	0.40	580	1.7
3650-2442	24	4200	120	3300	120	4	0.60	520	1.6

◆ Gearmotor Technical Data

36JX10K/3650-2430

Reduction ratio	4	5	14	19	27	51	71	100	139	189	264	369
Number of gear trains	2	2	3	3	3	4	4	4	4	5	5	5
Length(L) mm	35.5	35.5	35.5	35.5	35.5	41.5	41.5	41.5	41.5	47.5	47.5	47.5
No-load speed r/min	750	600	214	157	111	59	42	30	21	16	11	8
Rated speed r/min	625	500	178	131	92	49	35	25	18	13	9	7
Rated torque kg.cm	0.3	0.4	1.0	1.3	1.9	3.6	4.6	6.5	9.0	10	10	10
Max.permissible load in a short time kg.cm	5	5	10	10	10	20	20	20	20	30	30	30
Direction of rotation	CCW	CCW	CW	CW	CW	CCW	CCW	CCW	CCW	CW	CW	CW

36JX10K/3650-2436

Reduction ratio	4	5	14	19	27	51	71	100	139	189	264
Number of gear trains	2	2	3	3	3	4	4	4	4	5	5
Length(L) mm	35.5	35.5	35.5	35.5	35.5	41.5	41.5	41.5	41.5	47.5	47.5
No-load speed r/min	900	720	257	189	133	70	50	36	25	19	13
Rated speed r/min	750	600	214	157	111	59	42	30	21	16	11
Rated torque kg.cm	0.3	0.4	1.1	1.5	2.1	3.6	5.0	7.1	9.9	10	10
Max.permissible load in a short time kg.cm	5	5	10	10	10	20	20	20	20	30	30
Direction of rotation	CCW	CCW	CW	CW	CW	CCW	CCW	CCW	CCW	CW	CW

36JX10K/3650-2442

Reduction ratio	4	5	14	19	27	51	71	100	139	189	264
Number of gear trains	2	2	3	3	3	4	4	4	4	5	5
Length(L) mm	35.5	35.5	35.5	35.5	35.5	41.5	41.5	41.5	41.5	47.5	47.5
No-load speed r/min	1050	840	300	221	155	82	59	42	30	22	16
Rated speed r/min	825	660	235	173	122	64	46	33	23	17	12
Rated torque kg.cm	0.4	0.5	1.2	1.6	2.3	3.9	5.5	7.8	10	10	10
Max.permissible load in a short time kg.cm	5	5	10	10	10	20	20	20	20	30	30
Direction of rotation	CCW	CCW	CW	CW	CW	CCW	CCW	CCW	CCW	CW	CW

60JX300K/60105

PM DC PLANETARY GEARMOTOR

Introduction

1. Dia 60mm Planetary Gear Motor Rated Torque 300kg.cm (29Nm)
2. Motor power cable from rear.
3. Dia 56mm Planetary available (56JX300K)



• Dimensions

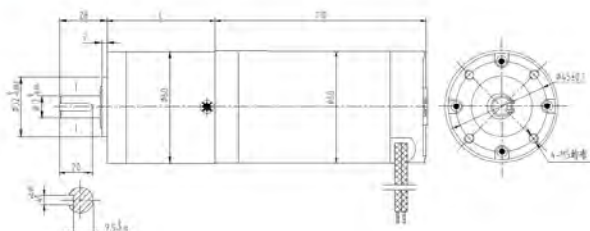

• Gearmotor Order Code

60JX300K x G12 / 60105-24x0
 Gearbox type Gear ratio Motor type (1 or 2)
 Shaft diameter

• Motor Technical Data

TYPE	Rated voltage VDC	No-load speed r/min	No-load current A	Rated speed r/min	Rated torque g.cm	Output power W	Rated current A	Stall torque kg.cm	Stall current A
1) 60105-2420	24	2000	0.32	1550	1250	20	1.6	5.5	6
2) 60105-2430	24	3000	0.4	2500	1200	30	2.2	7.2	10.8

• Gearmotor Technical Data

1) With Motor Type - 60105-2420

Reduction ratio	3.6	4.25	13	15	18	47	55	65	76	168	198	234	276	326
Number of gear stages	1	1	2	2	2	3	3	3	3	4	4	4	4	4
Length(L) mm	46.0	46.0	46.0	46.0	46.0	57.5	57.5	57.5	57.5	77.0	77.0	77.0	77.0	77.0
No-load speed r/min	555	470	154	133	111	42	36	30	26	12	10	8.5	7.2	6.1
Rated speed r/min	430	365	119	103	86	33	28	24	20	9.2	7.8	6.6	5.6	4.7
Rated torque kg. cm	4.3	5.0	14	17	20	50	58	73	81	170	200	237	279	300
Peak torque kg. cm	30	30	100	100	100	300	300	300	300	600	600	600	600	600
Max. permissible short time														

2) With Motor Type - 60105-2430

Reduction ratio	3.6	4.25	13	15	18	47	55	65	76	168	198	234	276	326
Number of gear stages	1	1	2	2	2	3	3	3	3	4	4	4	4	4
Length(L) mm	46.0	46.0	46.0	46.0	46.0	57.5	57.5	57.5	57.5	77.0	77.0	77.0	77.0	77.0
No-load speed r/min	833	706	230	200	167	64	54	46	39	18	15	13	11	9.2
Rated speed r/min	694	588	192	167	139	53	45	38	33	15	12	10	9.0	7.7
Rated torque kg. cm	4.1	4.8	14	16	19	48	56	66	77	163	192	227	268	300
Peak torque kg. cm	30	30	100	100	100	300	300	300	300	600	600	600	600	600
Max. permissible short time														

Other Motion Tech Products



Distributors for Australia & New Zealand

MOTION TECHNOLOGIES PTY LTD

24/22-30 Northumberland Road

Caringbah NSW 2229 Australia

Phone: (02) 9524 4782

Fax: (02) 9525 3878

sales@motiontech.com.au

www.motiontech.com.au

© 20/03/19