

JDT

Mechanical Linear Actuators

Descriptions	001
Permissible Critical Bucking Force	002
Sample Part Number	003 - 004
Specifications	005
Overall Dimensions	006 - 022
JDT22 (Without Proximity Limit Switches)	006
JDT22 (With Proximity Limit Switches)	007
JDT28 (Without Proximity Limit Switches)	008
JDT28 (With Proximity Limit Switches)	009
JDT28 With 63B14 Motor Flange Adapters	010
JDT28 With 56B5 Motor Flange Adapters	010
JDT32 (Without Proximity Limit Switches)	011
JDT32 (With Proximity Limit Switches)	012
JDT32 With 63B14 Motor Flange Adapters (0.18KW)	013
JDT32 With 71B14 Motor Flange Adapters (0.25KW, 0.37KW)	013
JDT35 (Without Proximity Limit Switches)	014
JDT35 (With Proximity Limit Switches)	015
JDT35 With 71B14 Motor Flange Adapters (0.25KW, 0.37KW)	016
JDT35 With 80B14 Motor Flange Adapters (0.55KW, 0.75KW)	016
JDT40 (Without Proximity Limit Switches)	017
JDT40 (With Proximity Limit Switches)	018
JDT40 With 71B5 Motor Flange Adapters	019
JDT40 With 80B14 Motor Flange Adapters	019
JDT56 (Without Proximity Limit Switches)	020
JDT56 (With Proximity Limit Switches)	021
JDT56 With 80B5, 90B4 Motor Flange Adapters	022
Other Products	023 - 026
Contact Us	027

Contents

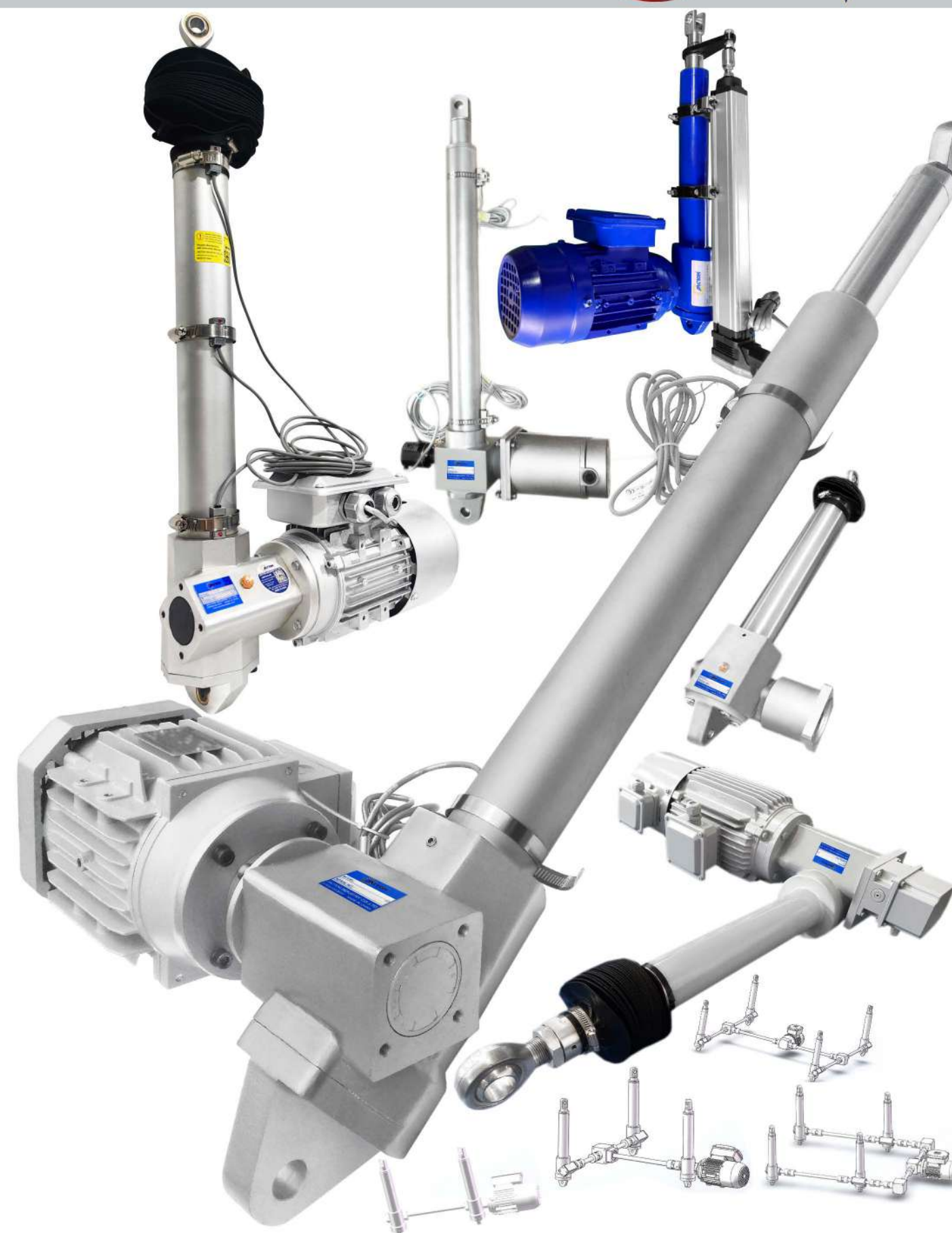



Descriptions

JDT Series Mechanical Linear Actuators: The compact integrations of the motor and gear reducer with the acme screw and ball screw, unique advantages in terms of the price and the performance provide much more space to the engineer for designing. The new idea dispensed with the consideration of the hydraulic and pneumatic leakage as well as the pipes and valves.

- **Synchronous Lifting:** the synchronous lifting can be achieved through the mechanical connection of multiple linear actuators, bevel gearboxes, couplings, connecting shafts, motor or gear reducer.
- **Self-locking:** The majority of the products possess the self-locking function, thus increasing the performance security.
- **Precise Positioning:** the positioning accuracy can reach 0.1mm.
- **Precise Control:** equipped with encoder, potentiometer or rotary transformer, the closed loop positioning can also be realized through the inverter, PLC controller and the servo controller.
- **Overload Protection:** can be equipped with the safety clutch, and the over-load sensor.
- **Others:** Easy maintenance, low noise, can work normally under the harsh environment of high or low temperature, corrosive and explosive-prone environment.

Permissible Critical Bucking Force

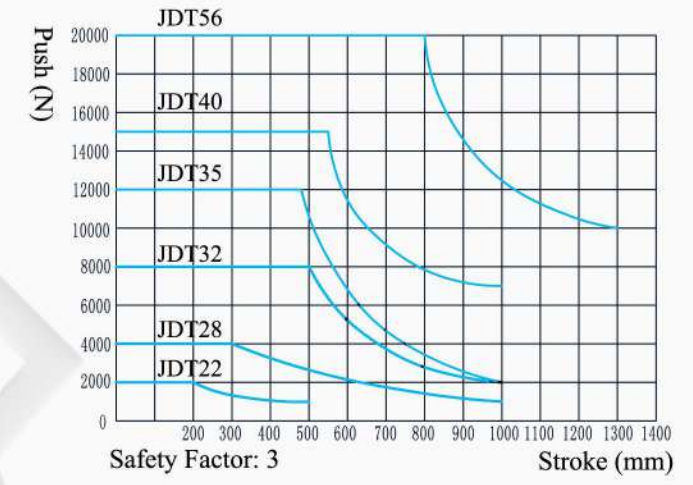
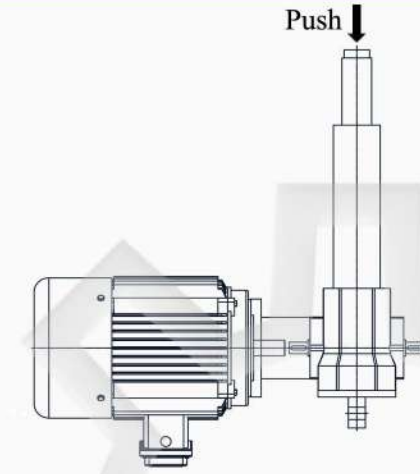

Selection Notes

- The percentage of the duty cycle within 10 minutes
- * JDT22 Mechanical Linear Actuator (Acme Screw): 25%
- * JDT28, JDT32, JDT35, JDT40, JDT56 Mechanical Linear Actuators (Acme Screw): 30%
- * The duty cycle can be increased if the actual load is less than the rated loads, please consult with the engineers for the specifics.
- * Please confirm the self-locking, and refer to the table of self-locking coefficients, choose the appropriate self-locking according to the actual application. To the acme screw and ball screw linear actuators without self-locking function, please match the brake with them.
- * For the acme screw and the ball screw linear actuator with the stroke of 300mm, the axial error is 0.1mm.
- * For special custom design, please consult with engineers.

Self-locking Conditions for the Mechanical Linear Actuators

- The self-locking state of the actuators can be categorized into four types as follows:
 - **Static Self-locking**
 - * Self-locking coefficients is less than 0.35.
 - The actuator will not move under the external push or pull load, provided that there is not vibration.
 - **Dynamic Self-locking**
 - * Self-locking coefficient is less than 0.3.
 - If the load direction is opposite to the move direction, the actuator does not move in the case of power off.
 - * Self-locking coefficient is less than 0.25
 - If the load direction is the same as the move direction, the actuator does not move in the case of power off.
 - **Uncertain Self-locking**
 - * The self-locking coefficient is between 0.35 and 0.55.
 - The actuator will move up and down under the increased external load.
 - **Non Self-locking**
 - * Self-locking coefficient is above 0.55.
 - The actuator will move up and down under a minimum load.

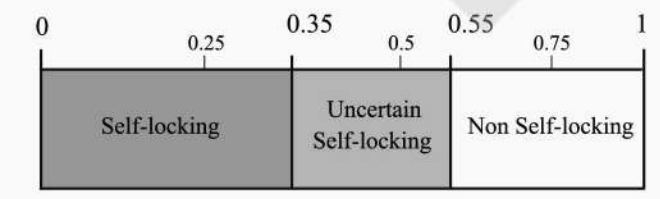



Sample Part Number

JDT28 - US - 300 - L - II - C - BB
 (1) (2) (3) (4) (5) (6) (7)

■ (1) Models & (4) Gear Ratios

JDT22 H(4:1), M(8:1), L(16:1)	JDT28 H(6:1), H1(8:1), M(12:1), L(24:1)	JDT32 H(6:1), H1(8:1), M(12:1), L(24:1)
JDT35 H(4:1), M(8:1), L(16:1)	JDT40 H(5:1), M(10:1), L(20:1)	JDT56 H(6:1), M(12:1), L(24:1)

■ (2) Designs and Configurations

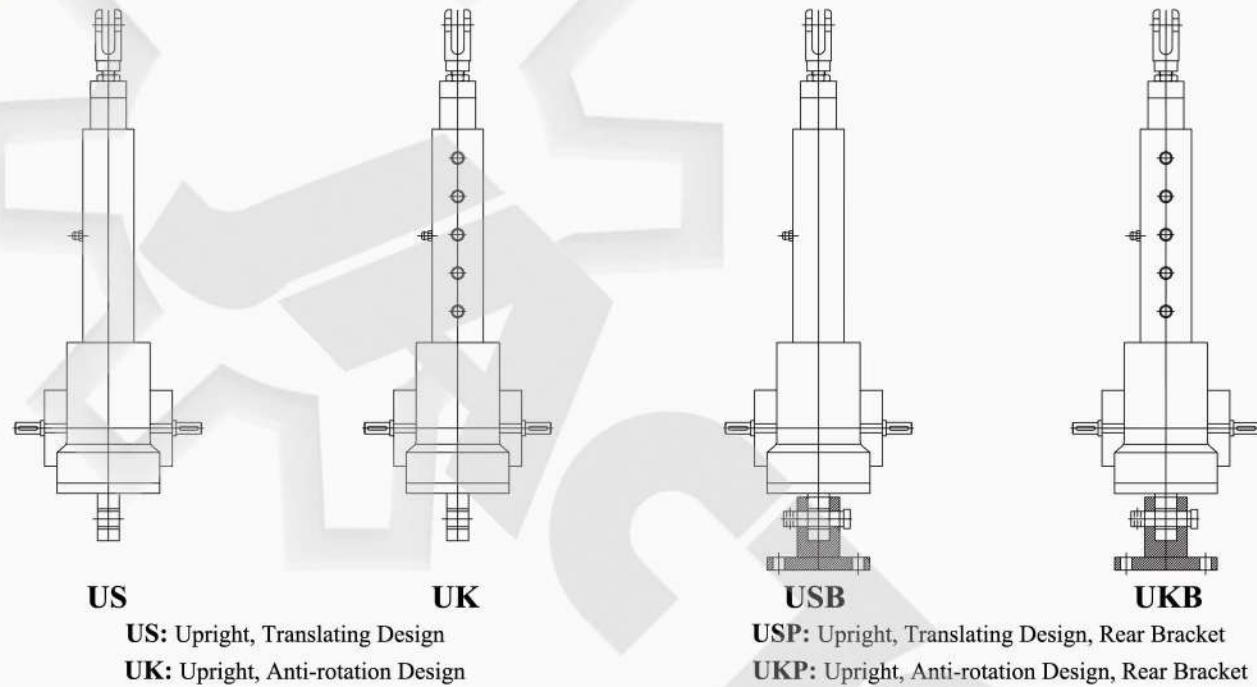

■ (3) Stroke & (5) End Fittings

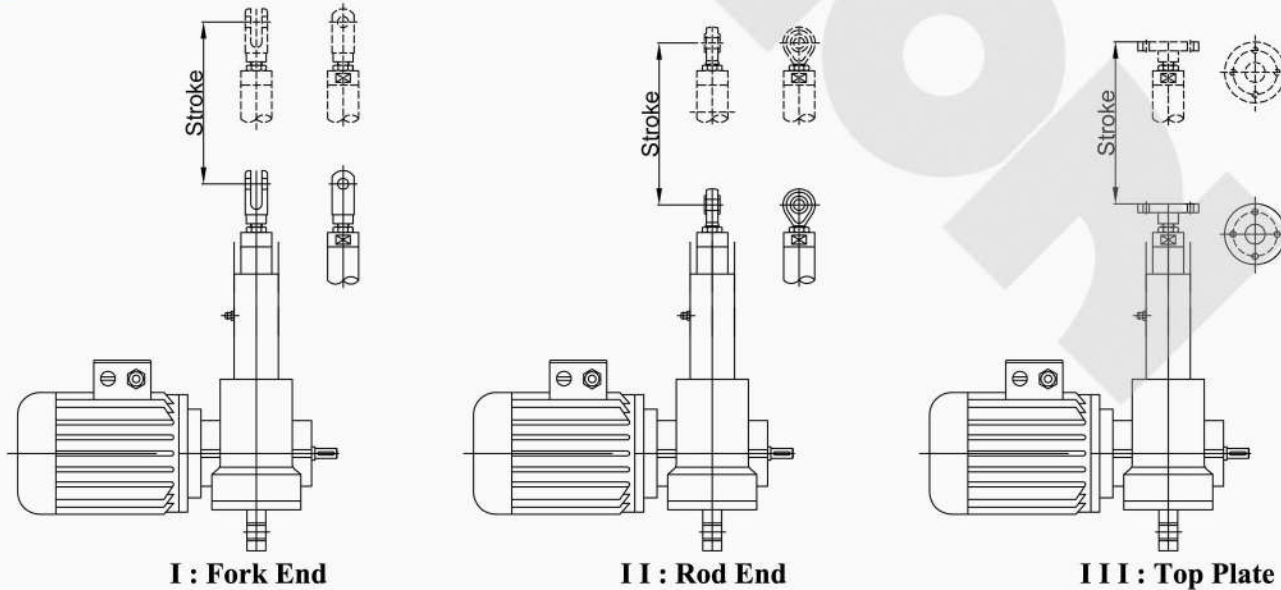

Sample Part Number

■ (6) Input Shafts Types & Motor Flange Types

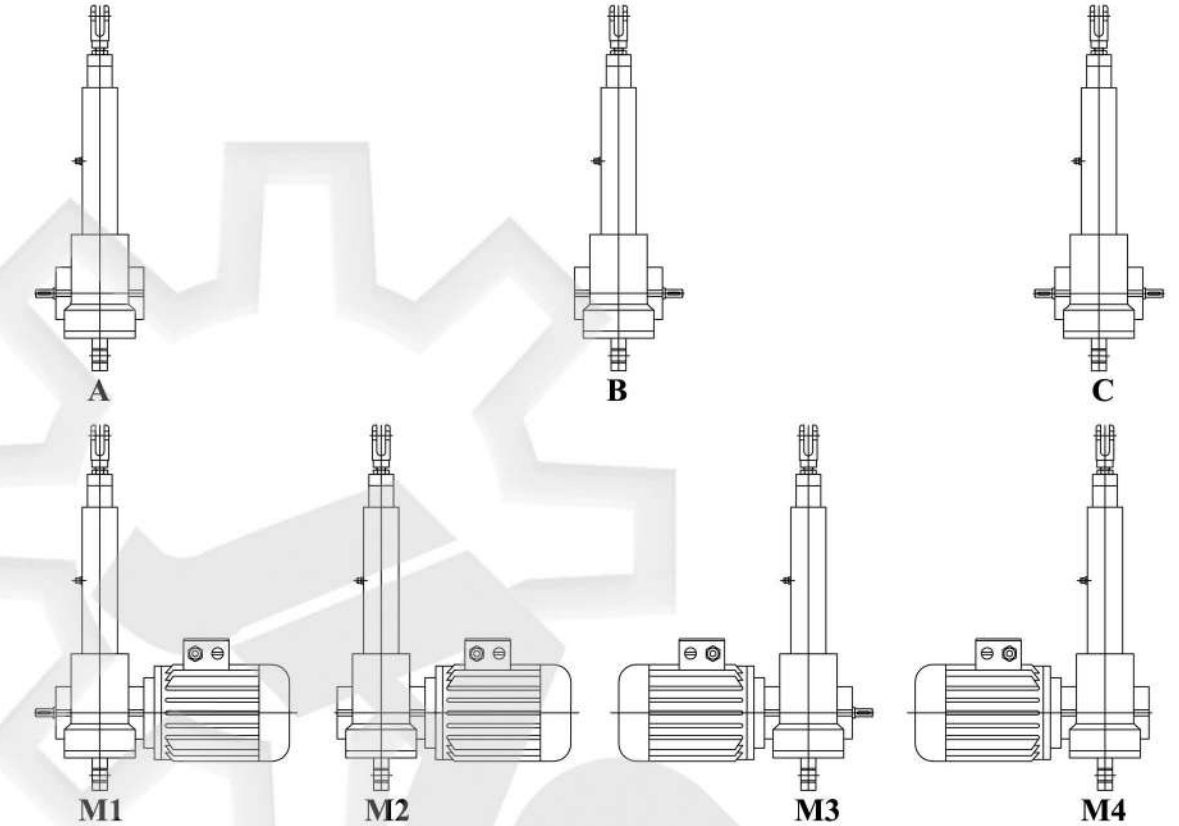

■ (7) Accessories

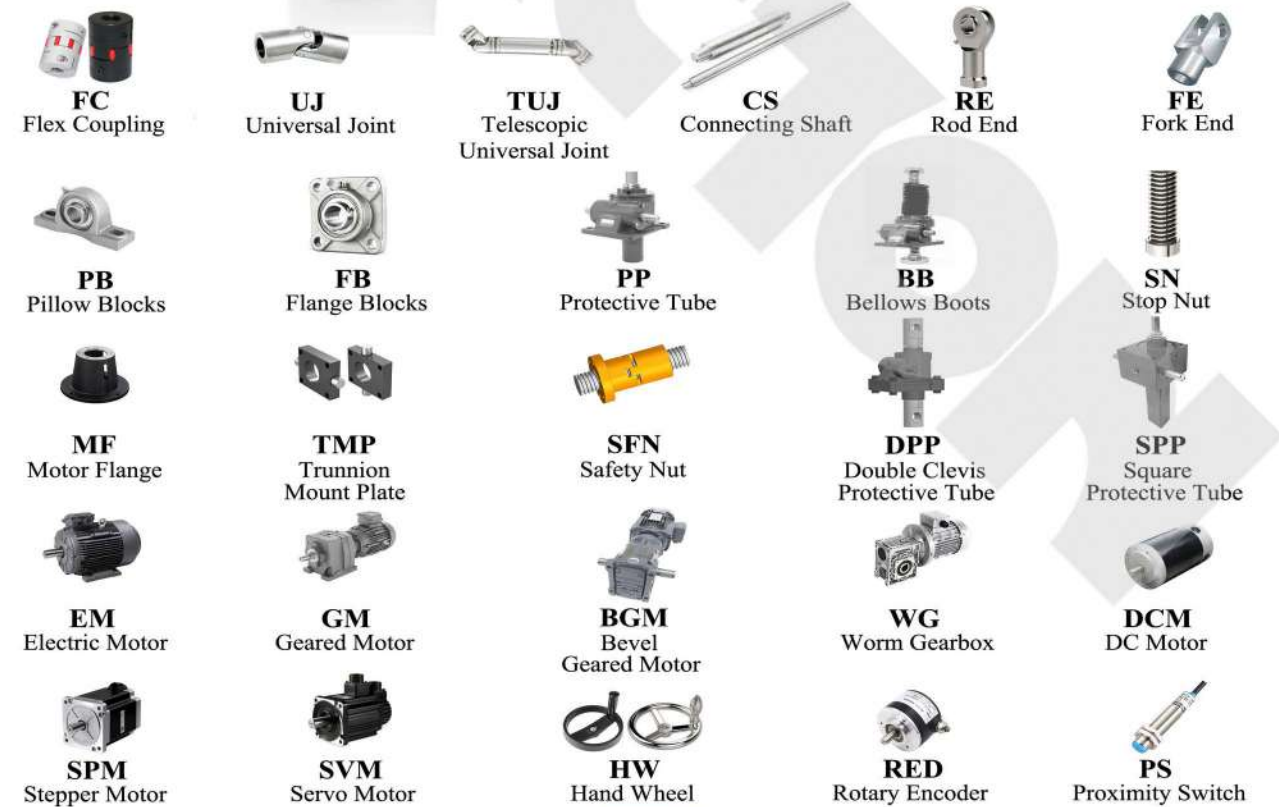



Specifications

* Performance Table of JDT Series With AC 3-Phase Motor

Model	Lift Speed (mm/min)	Dynamic Load (N)	Gear Ratio		Motor Technical Parameters
JDT22	348	700	L	16:1	90W / 4P-1400RPM 3-Phase 380V / 50Hz
	696	500	M	8:1	
	1380	300	H	4:1	
JDT28	228	2000	L	24:1	180W / 4P-1400RPM 3-Phase 380V / 50Hz
	468	1000	M	12:1	
	684	1000	H1	8:1	
JDT32	912	700	H	6:1	250W / 4P-1400RPM 3-Phase 380V / 50Hz
	228	4000	L	24:1	
	468	3000	M	12:1	
JDT35	684	2000	H1	8:1	550W / 4P-1400RPM 3-Phase 380V / 50Hz
	912	1000	H	6:1	
	348	6000	L	16:1	
JDT40	696	4000	M	8:1	370W / 4P-1400RPM 3-Phase 380V / 50Hz
	1380	2000	H	4:1	
	348	8000	L	20:1	
JDT56	696	5000	M	10:1	750W / 4P-1400RPM 3-Phase 380V / 50Hz
	1380	3000	H	5:1	
	348	12000	L	24:1	
JDT56	696	10000	M	12:1	1100W / 4P-1400RPM 3-Phase 380V / 50Hz
	1380	7000	H	6:1	
	1380	7000	H	6:1	

* If you require the Mechanical Linear Actuators with slower speed, you can use a gear reducer or use a geared motor. If you require the Mechanical Linear Actuators with higher speed, Choose from a 2-pole 2800rpm motor or a large lead acme screw or ball screw, please contact the engineers for details.

Overall Dimensions

JDT22 (Without Proximity Limit Switches)

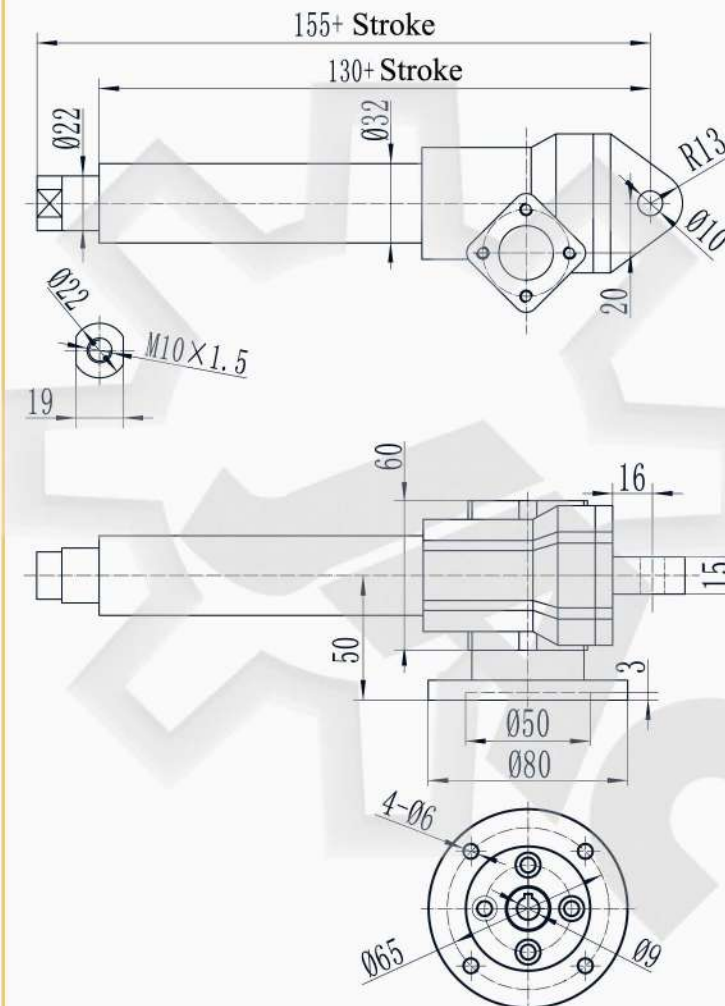

Rear Bracket

Pin

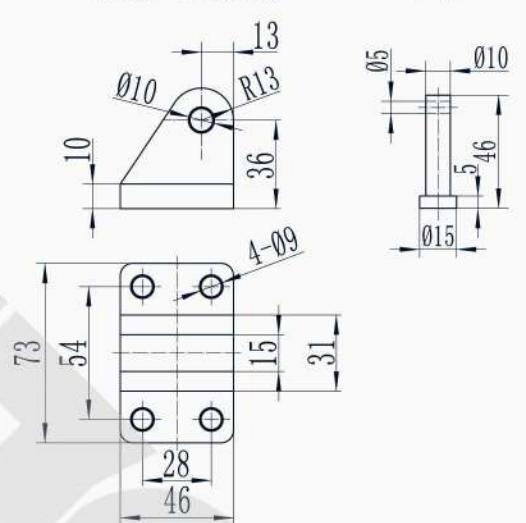

End Fittings

I : Fork End

II : Rod End

III : Top Plate

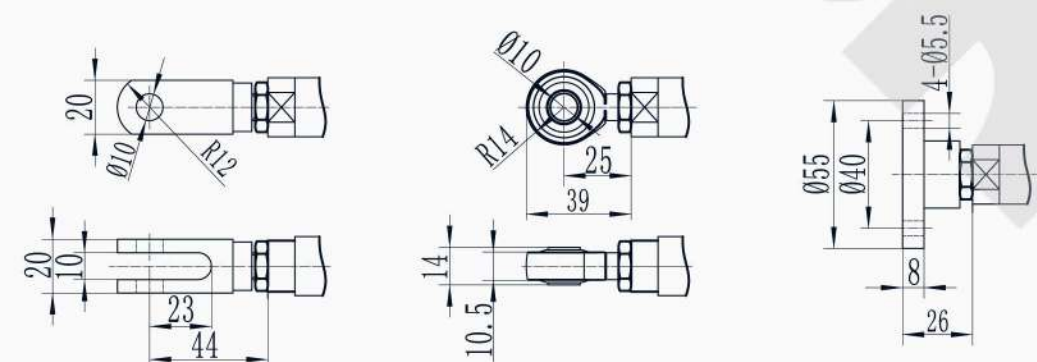

*. Dimensions are subject to change without notice



Overall Dimensions

JDT22 (With Proximity Limit Switches)

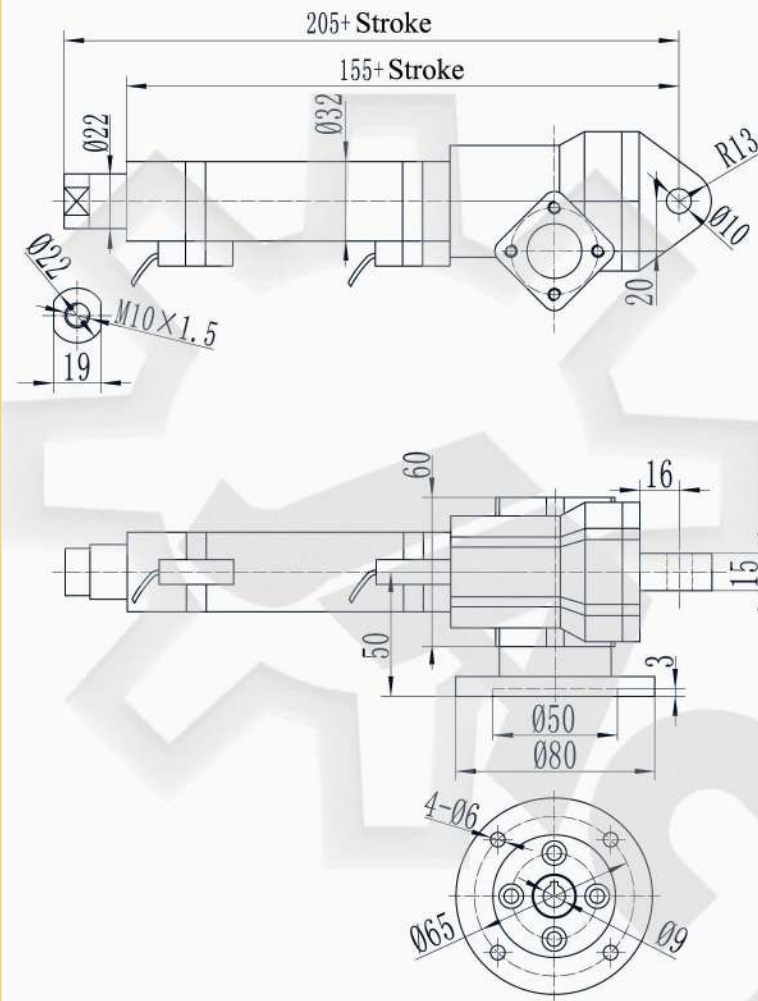

Rear Bracket

Pin

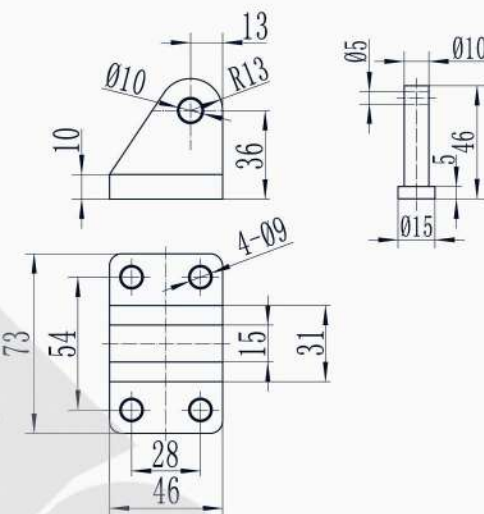

End Fittings

I : Fork End

II : Rod End

III : Top Plate

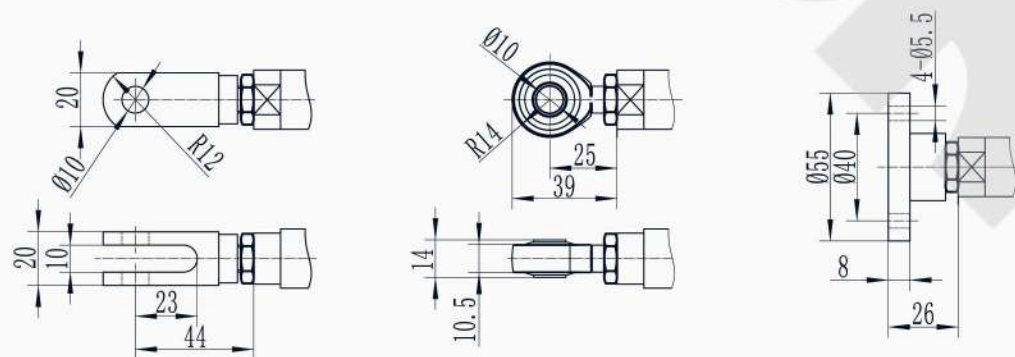

*. Dimensions are subject to change without notice

Overall Dimensions

JDT28 (Without Proximity Limit Switches)

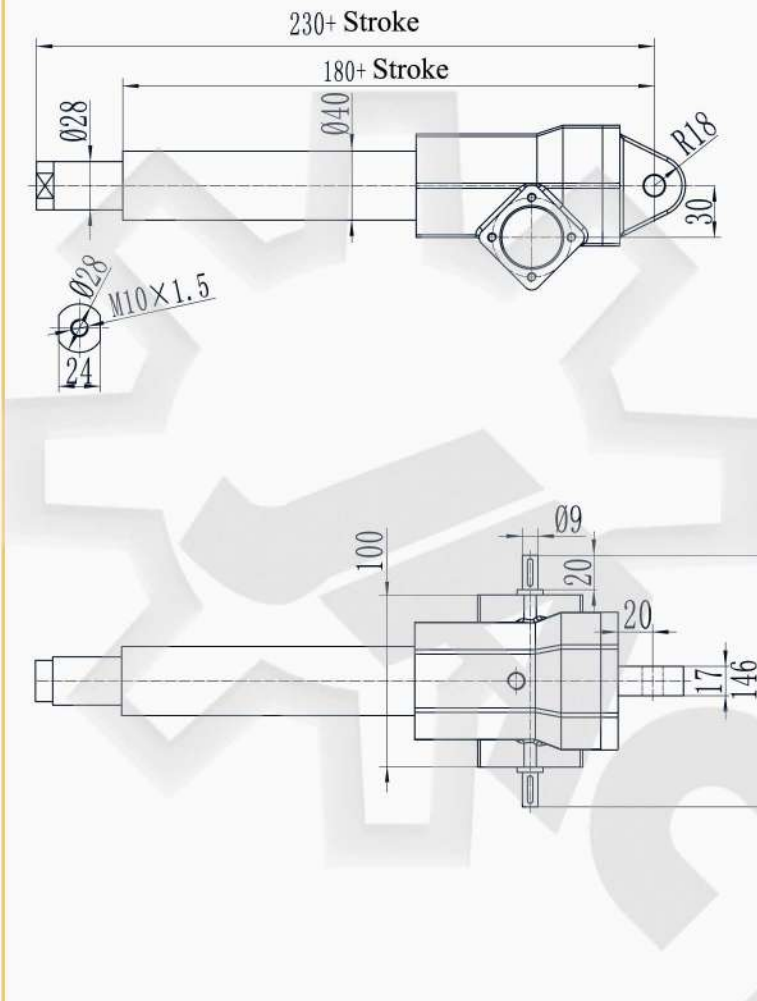

Rear Bracket

Pin

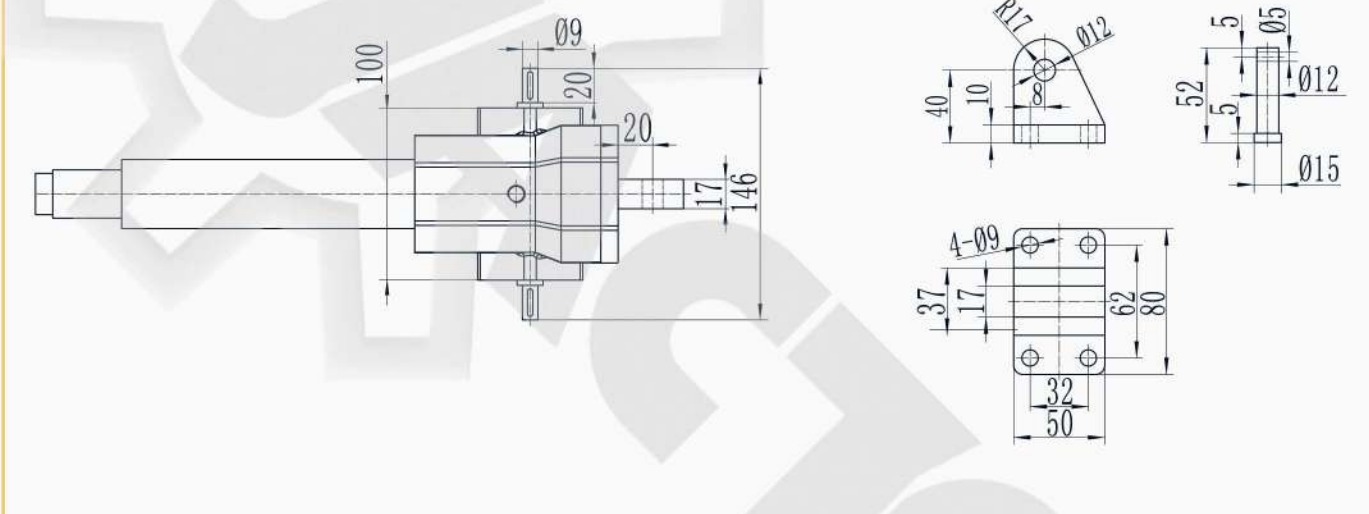

End Fittings

I : Fork End

II : Rod End

III : Top Plate

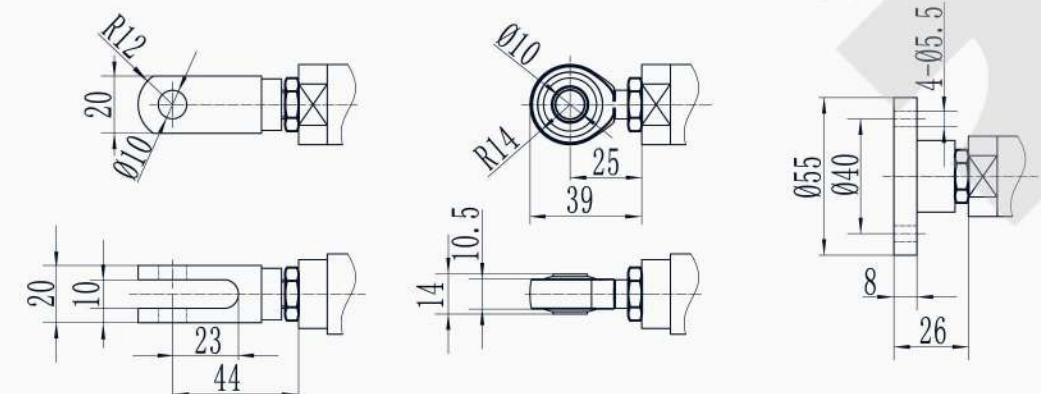

*. Dimensions are subject to change without notice



Overall Dimensions

JDT28 (With Proximity Limit Switches)

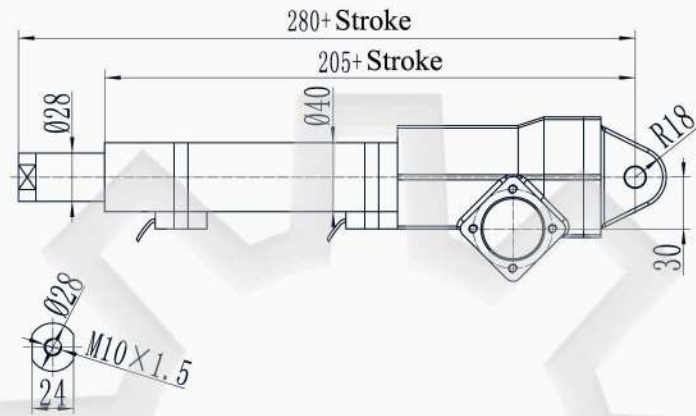

Rear Bracket

Pin

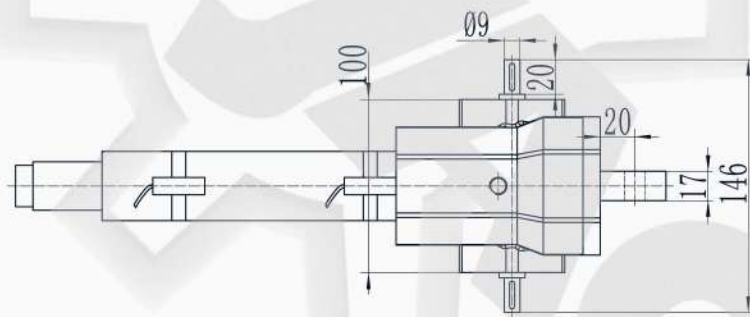
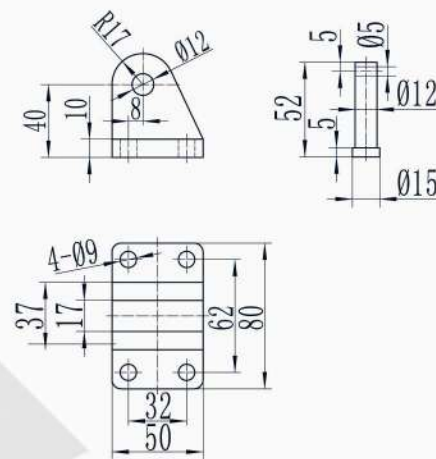

End Fittings

I : Fork End

II : Rod End

III : Top Plate

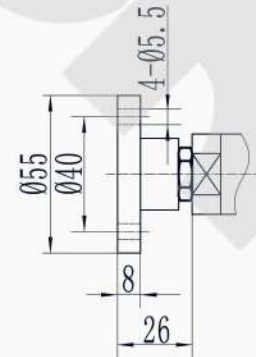
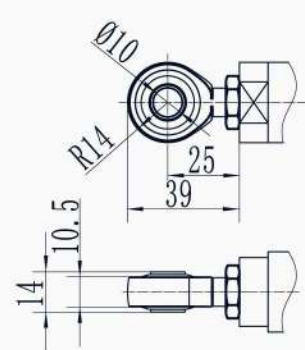
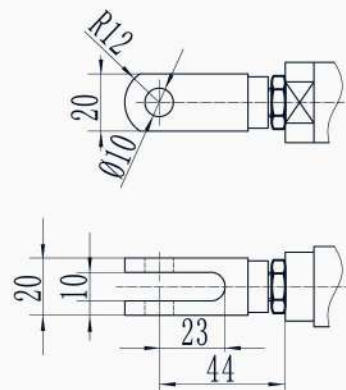

*. Dimensions are subject to change without notice

Overall Dimensions

JDT28 With 63B14 Motor Flange Adapters

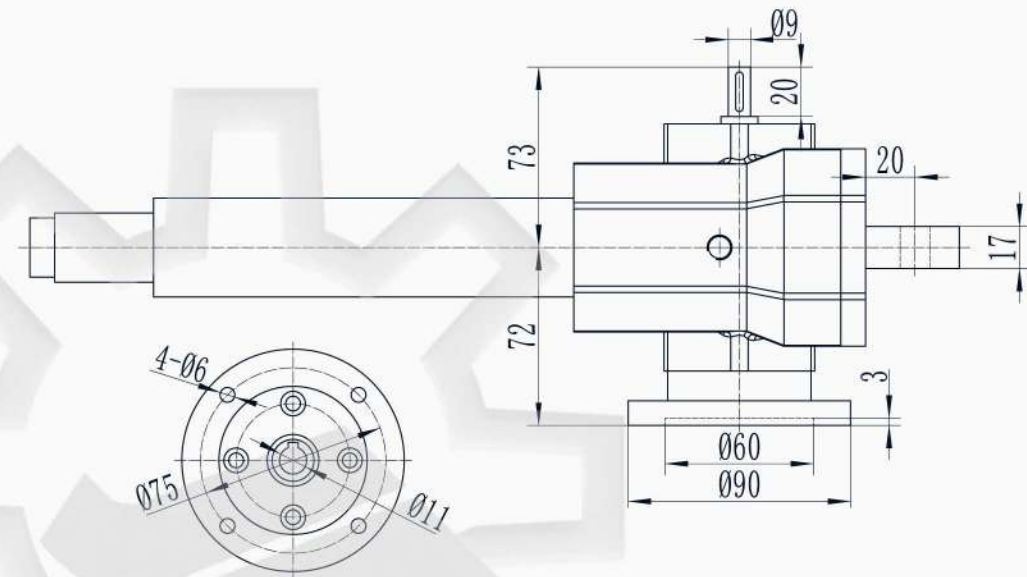

JDT28 With 56B5 Motor Flange Adapters

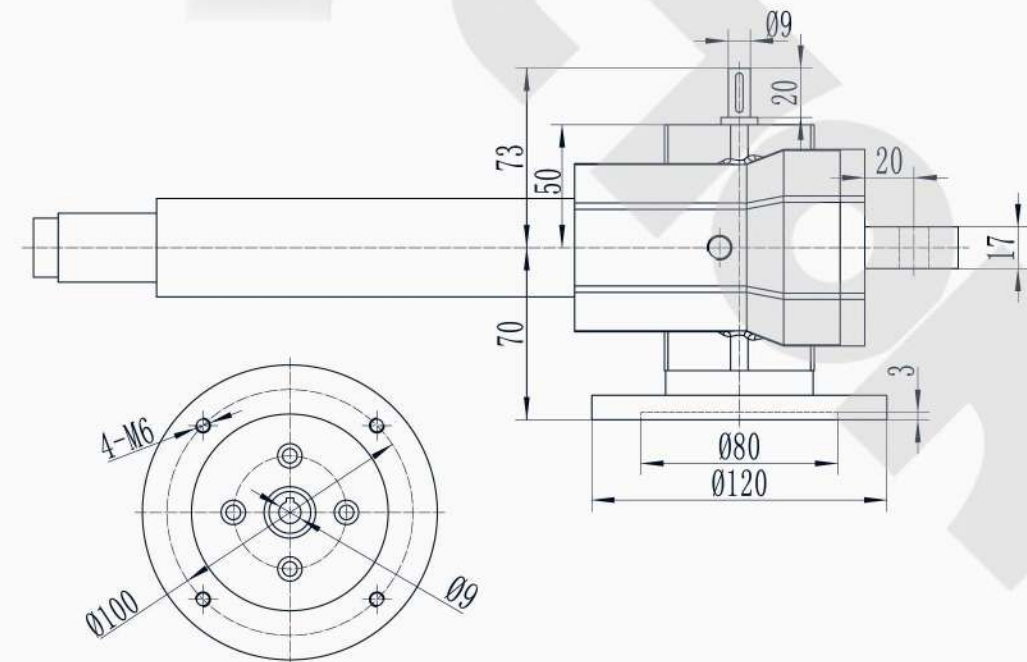

*. Dimensions are subject to change without notice



Overall Dimensions

JDT32 (Without Proximity Limit Switches)

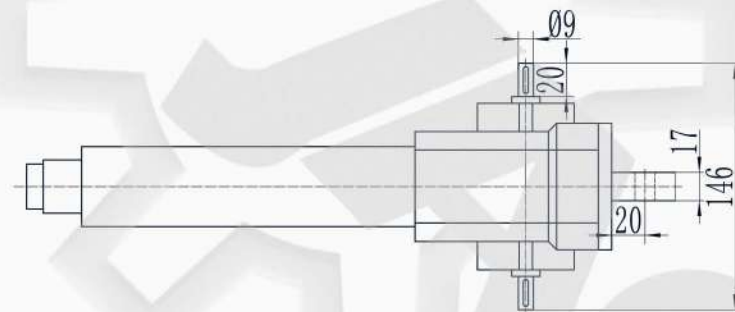
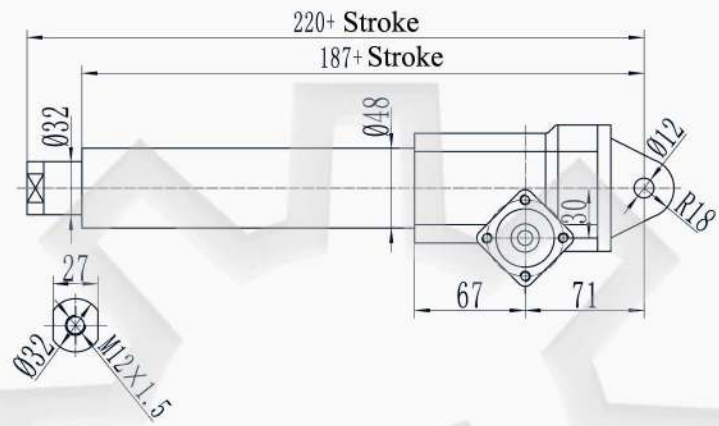

Rear Bracket

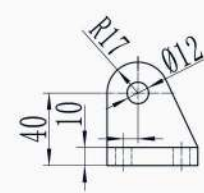

Pin

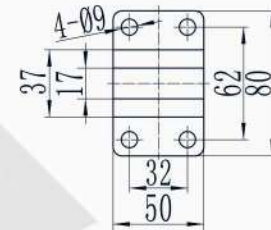
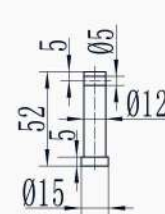

Overall Dimensions

JDT32 (With Proximity Limit Switches)

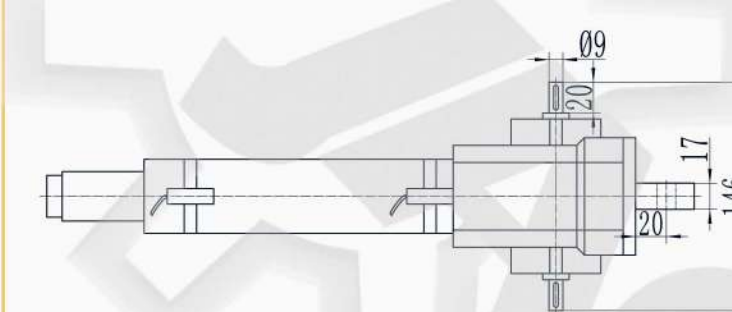
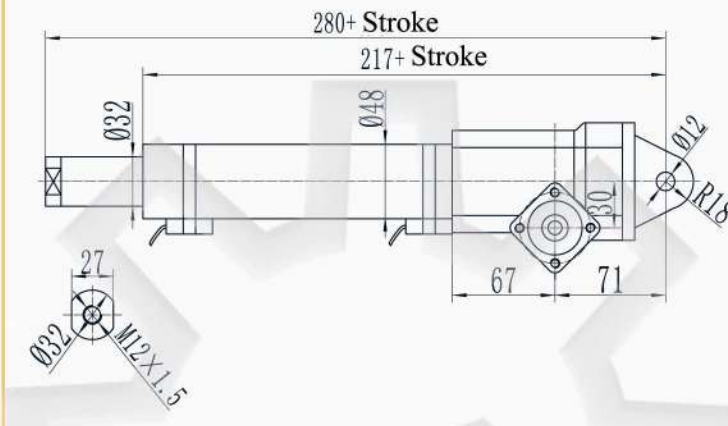

Rear Bracket

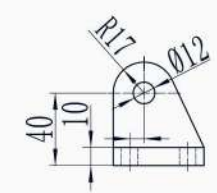

Pin

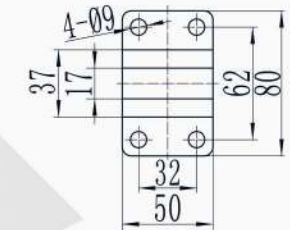
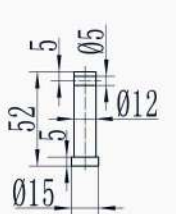

End Fittings

I : Fork End

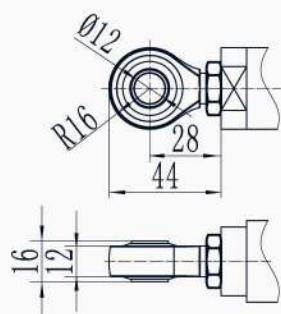

II : Rod End

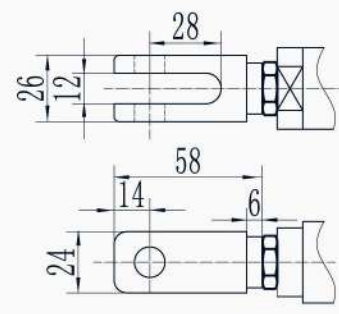

III : Top Plate

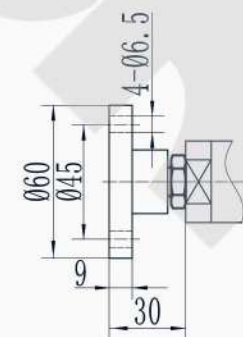

End Fittings

I : Fork End

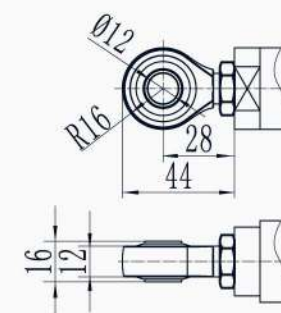

II : Rod End

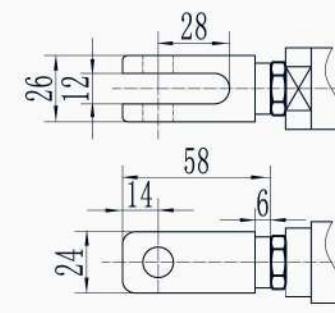

III : Top Plate

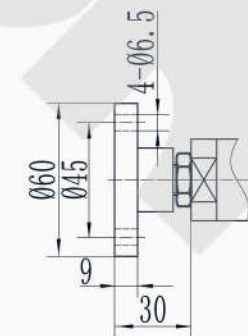

*. Dimensions are subject to change without notice

*. Dimensions are subject to change without notice



Overall Dimensions

JDT32 With 63B14 Motor Flange Adapters (0.18KW)

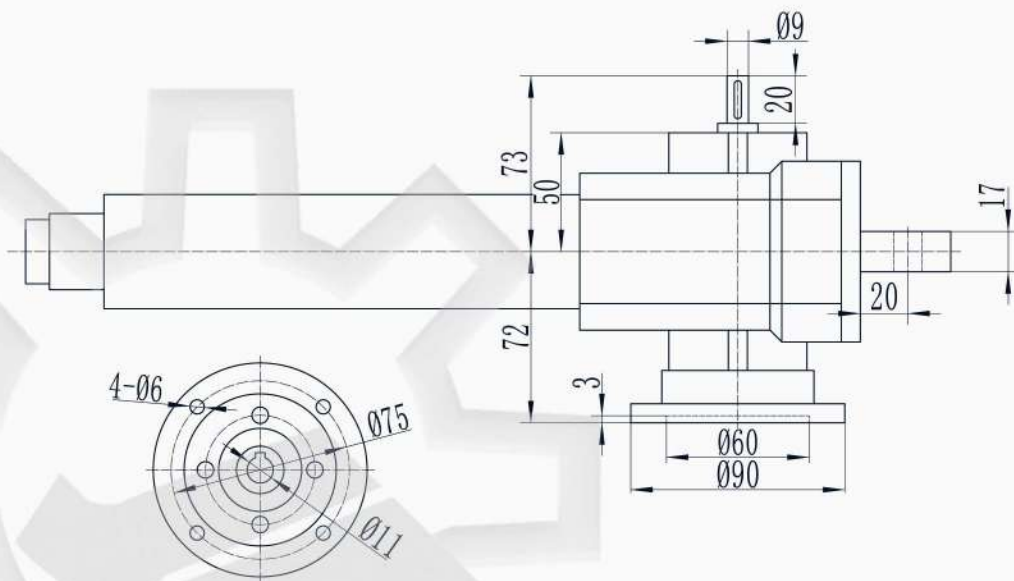

JDT32 With 71B14 Motor Flange Adapters (0.25KW, 0.37KW)

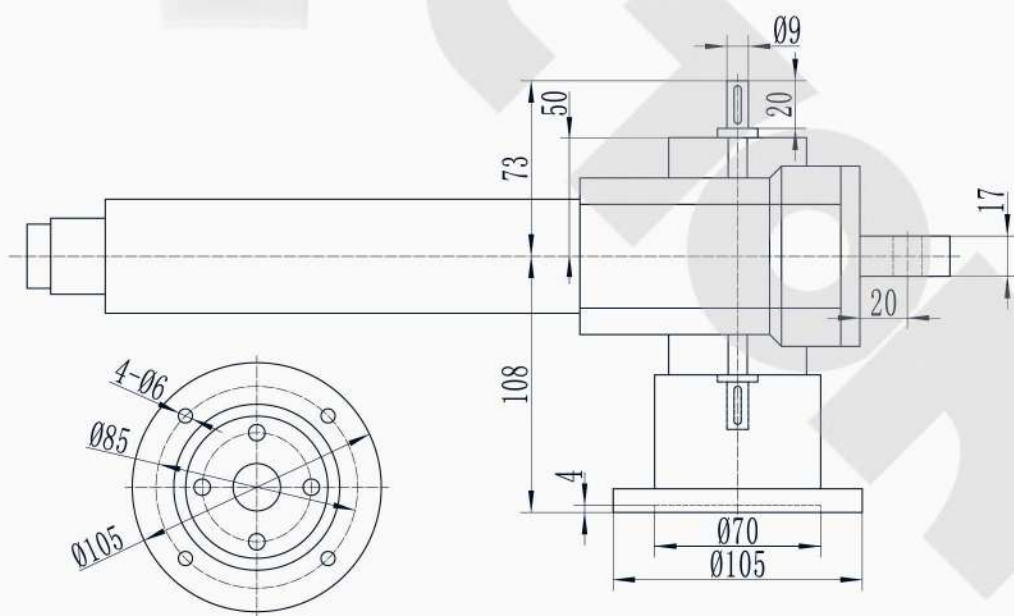

*. Dimensions are subject to change without notice

Overall Dimensions

JDT35 (Without Proximity Limit Switches)

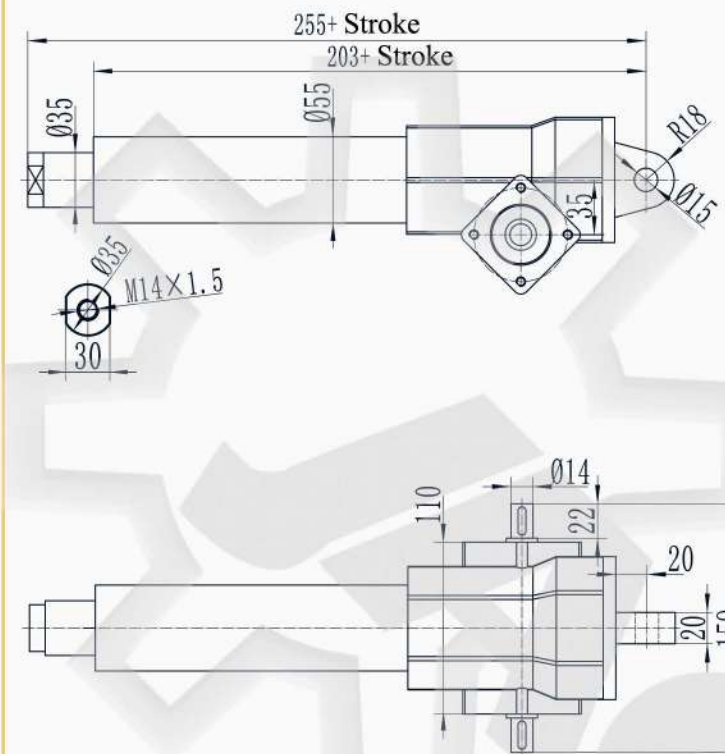

Rear Bracket

Pin

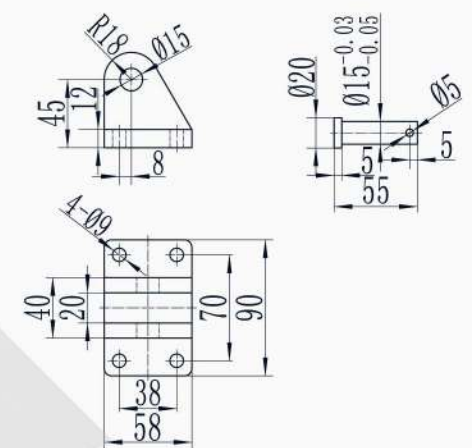

End Fittings

I : Fork End

II : Rod End

III : Top Plate

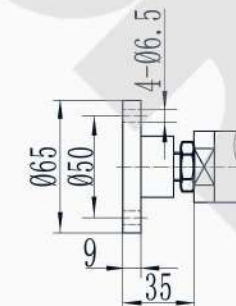
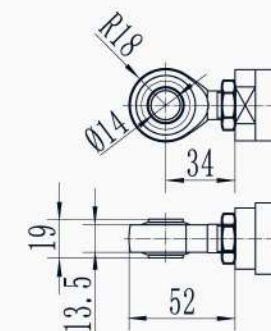
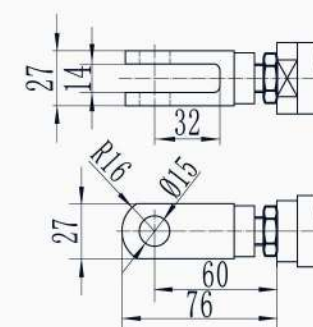

*. Dimensions are subject to change without notice



Overall Dimensions

JDT35 (With Proximity Limit Switches)

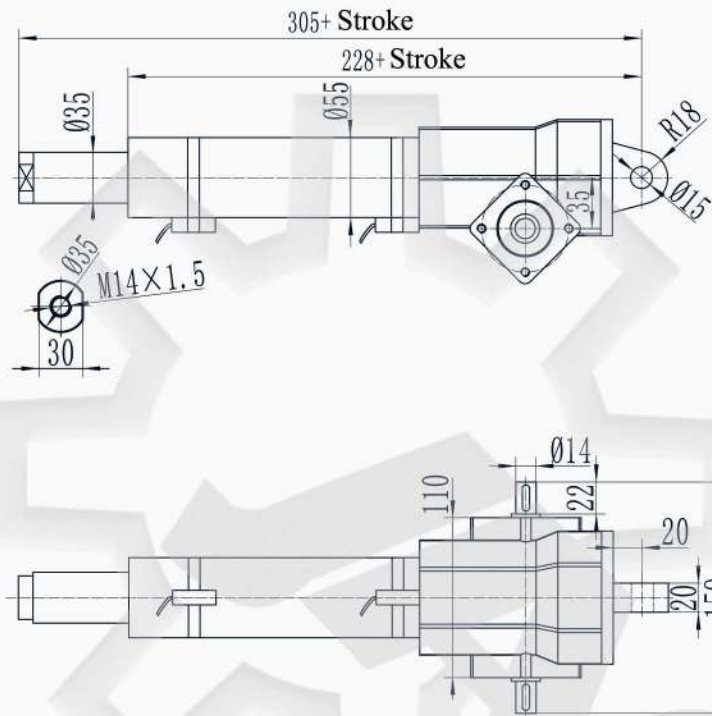

Rear Bracket

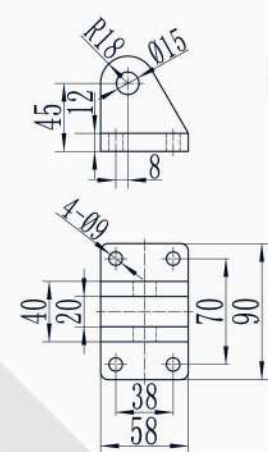

Pin

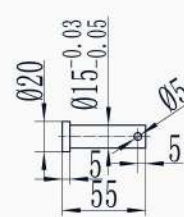

End Fittings

I : Fork End

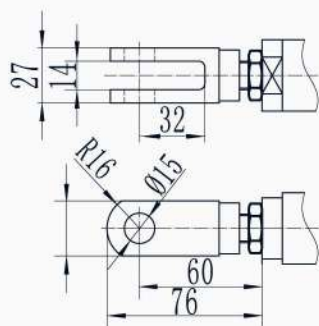

II : Rod End

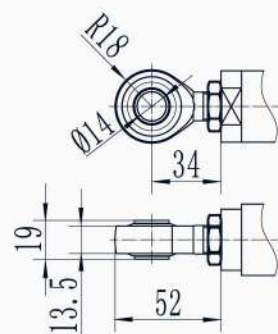

III : Top Plate

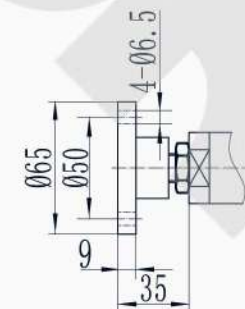

*. Dimensions are subject to change without notice

Overall Dimensions

JDT35 With 71B14 Motor Flange Adapters (0.25KW, 0.37KW)

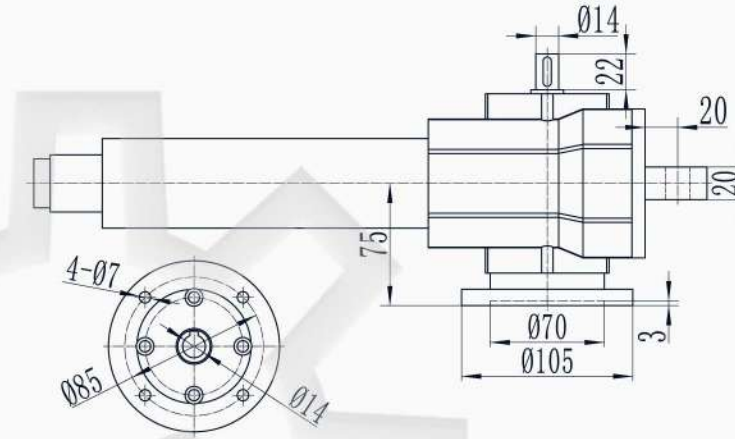

JDT35 With 80B14 Motor Flange Adapters (0.55KW, 0.75KW)

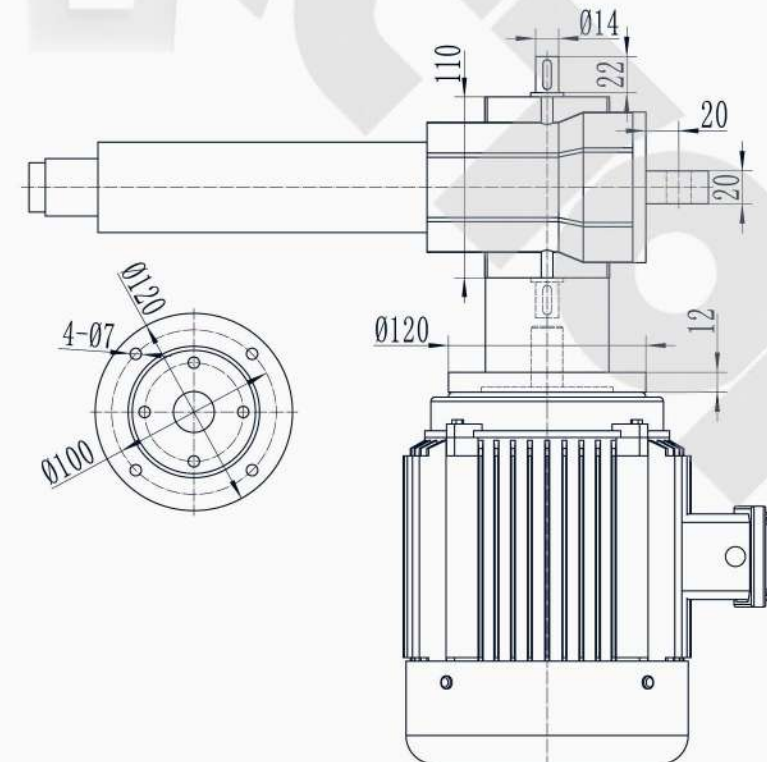

*. Dimensions are subject to change without notice



Overall Dimensions

JDT40 (Without Proximity Limit Switches)

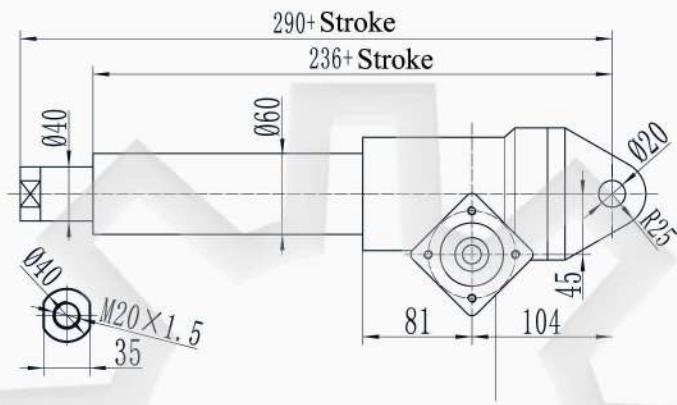

Rear Bracket

Pin

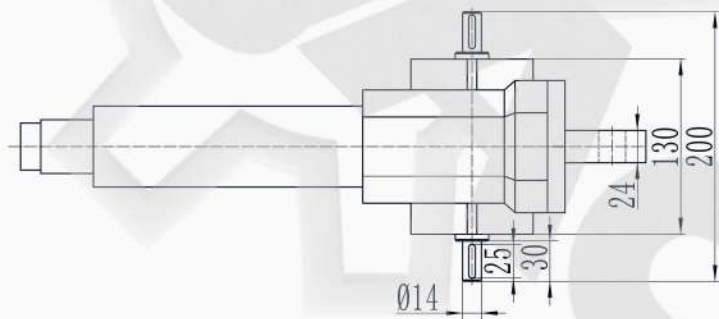
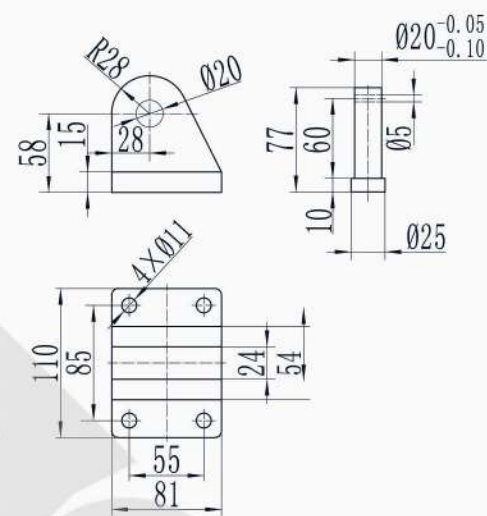

End Fittings

I : Fork End

II : Rod End

III : Top Plate

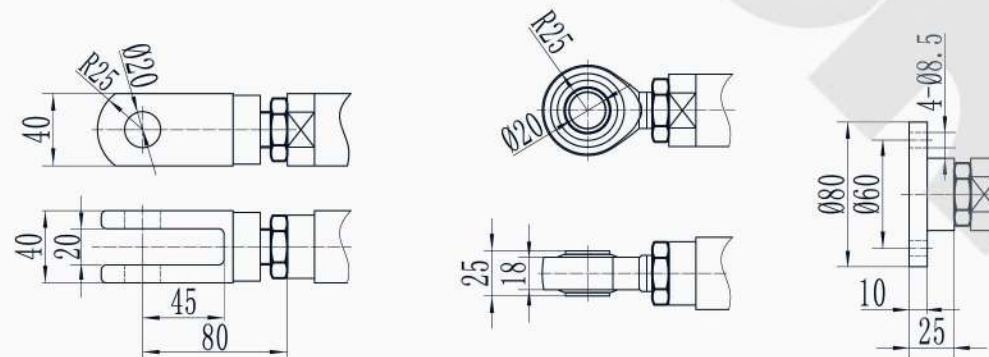

Overall Dimensions

JDT40 (With Proximity Limit Switches)

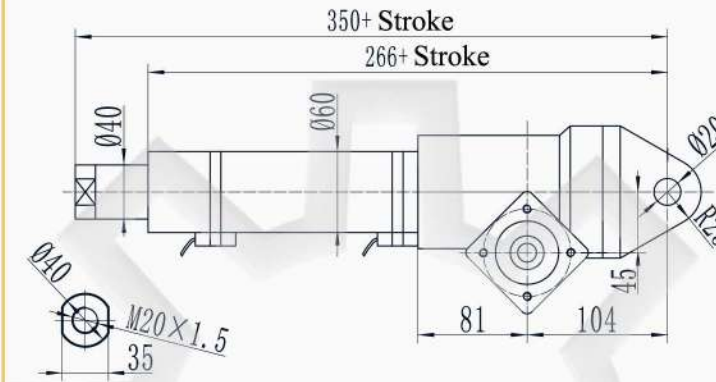

Rear Bracket

Pin

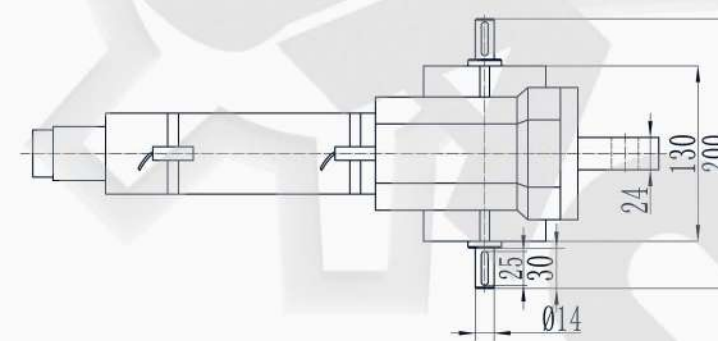
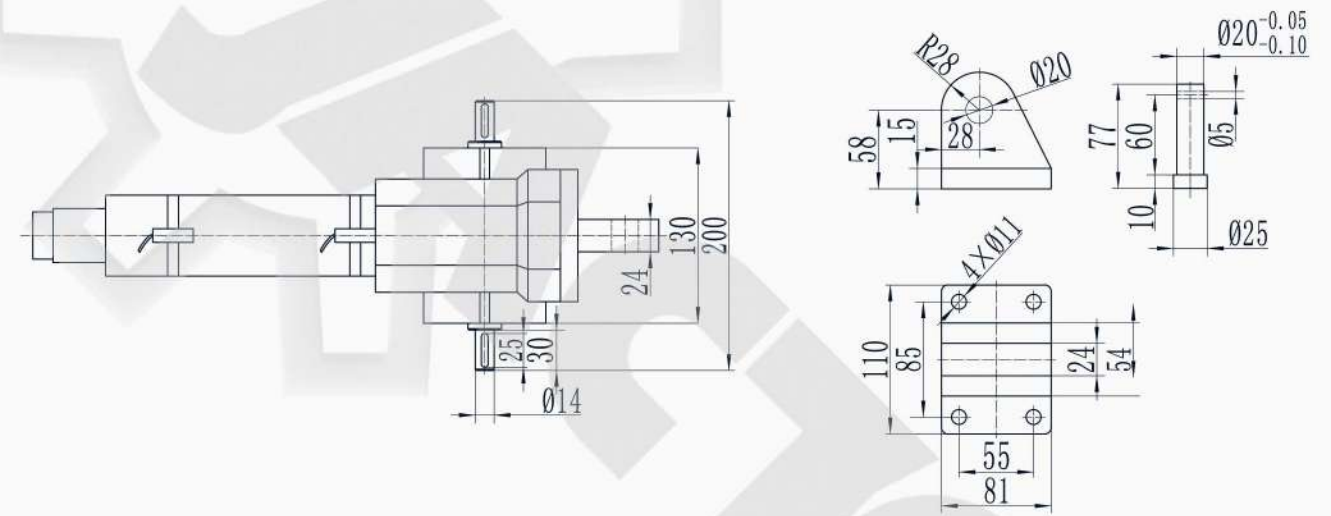

End Fittings

I : Fork End

II : Rod End

III : Top Plate

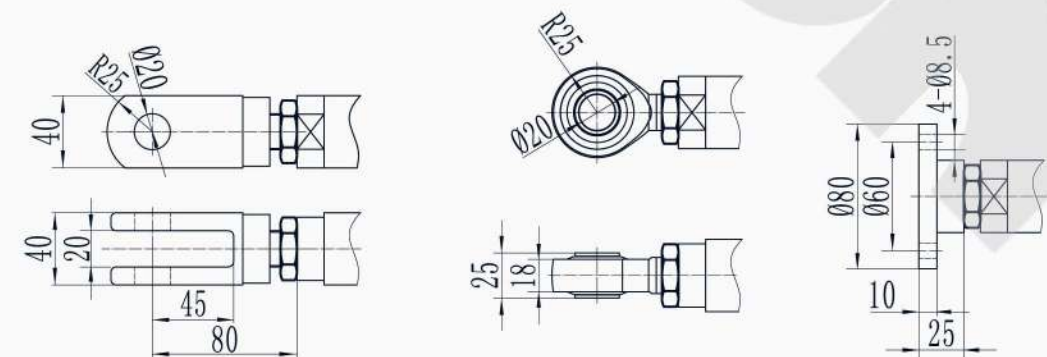



Overall Dimensions

JDT40 With 71B5 Motor Flange Adapters

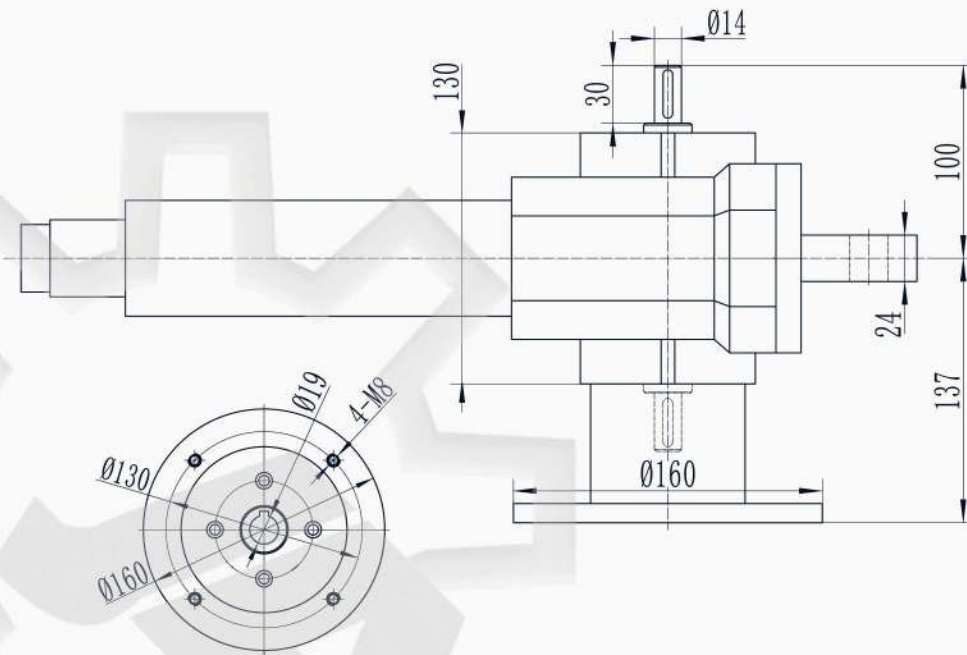

JDT40 With 80B14 Motor Flange Adapters

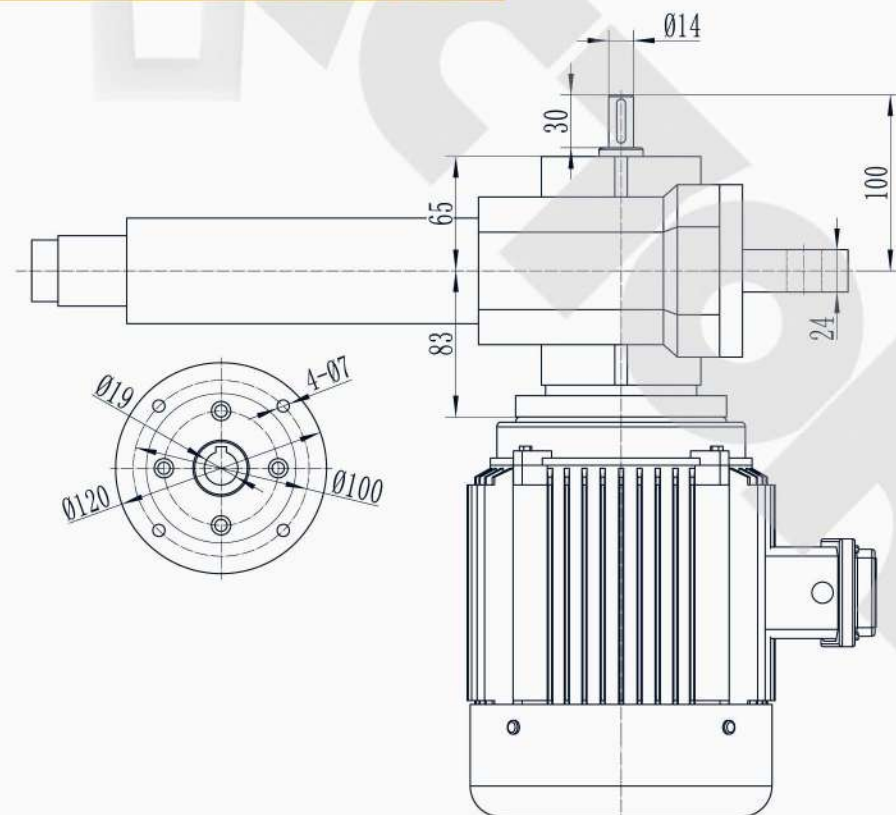

*. Dimensions are subject to change without notice

019

Overall Dimensions

JDT56 (Without Proximity Limit Switches)

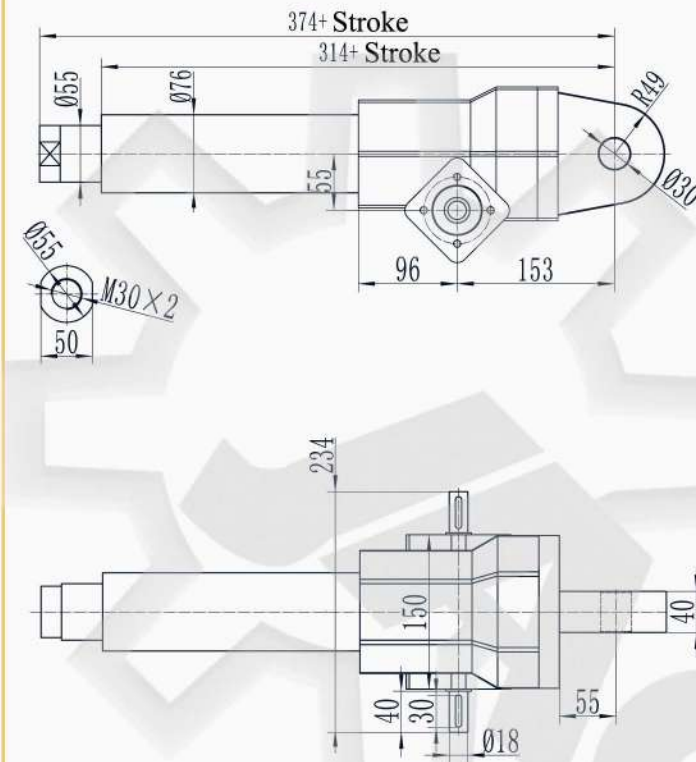

Rear Bracket

Pin

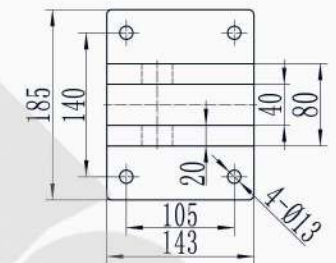
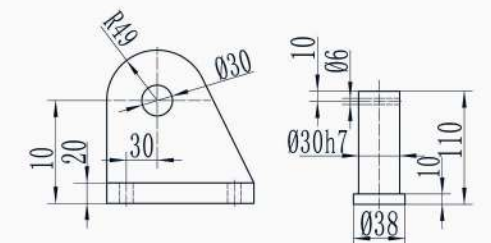

End Fittings

I : Fork End

II : Rod End

III : Top Plate

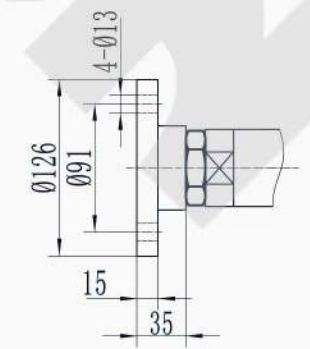
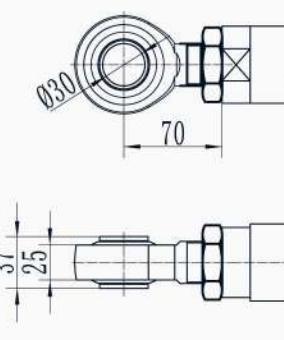
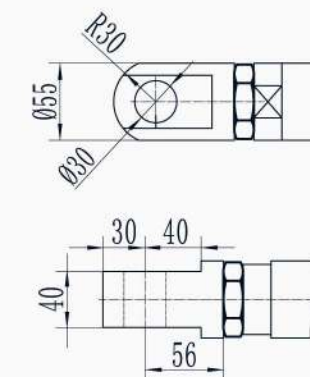

*. Dimensions are subject to change without notice

020



Overall Dimensions

JDT56 (With Proximity Limit Switches)

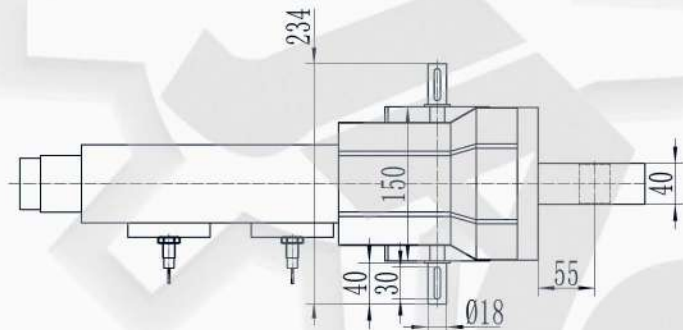
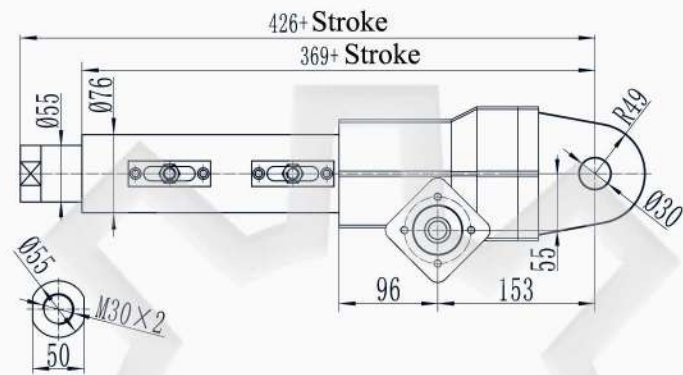

Rear Bracket

Pin

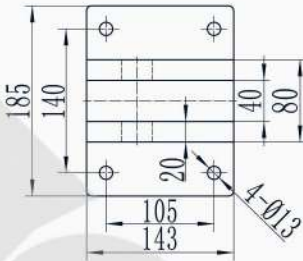
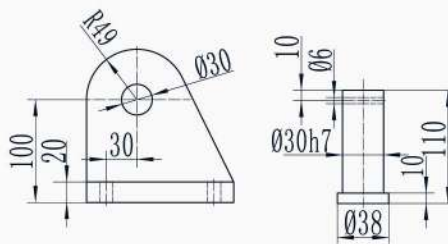

End Fittings

I : Fork End

II : Rod End

III : Top Plate

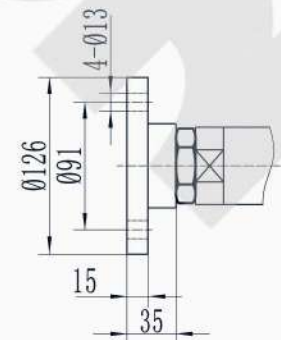
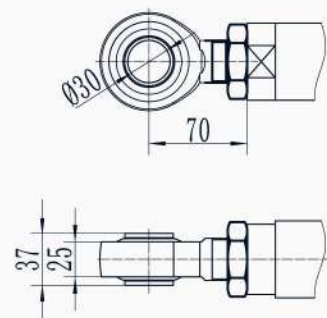
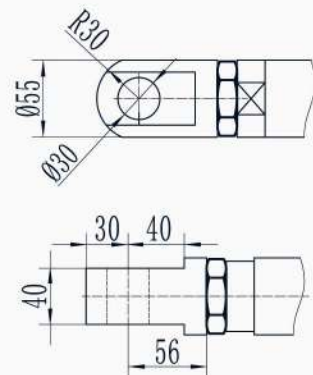

*. Dimensions are subject to change without notice

Overall Dimensions

JDT56 With 80B5, 90B4 Motor Flange Adapters

(Y80B5 Y90B5)

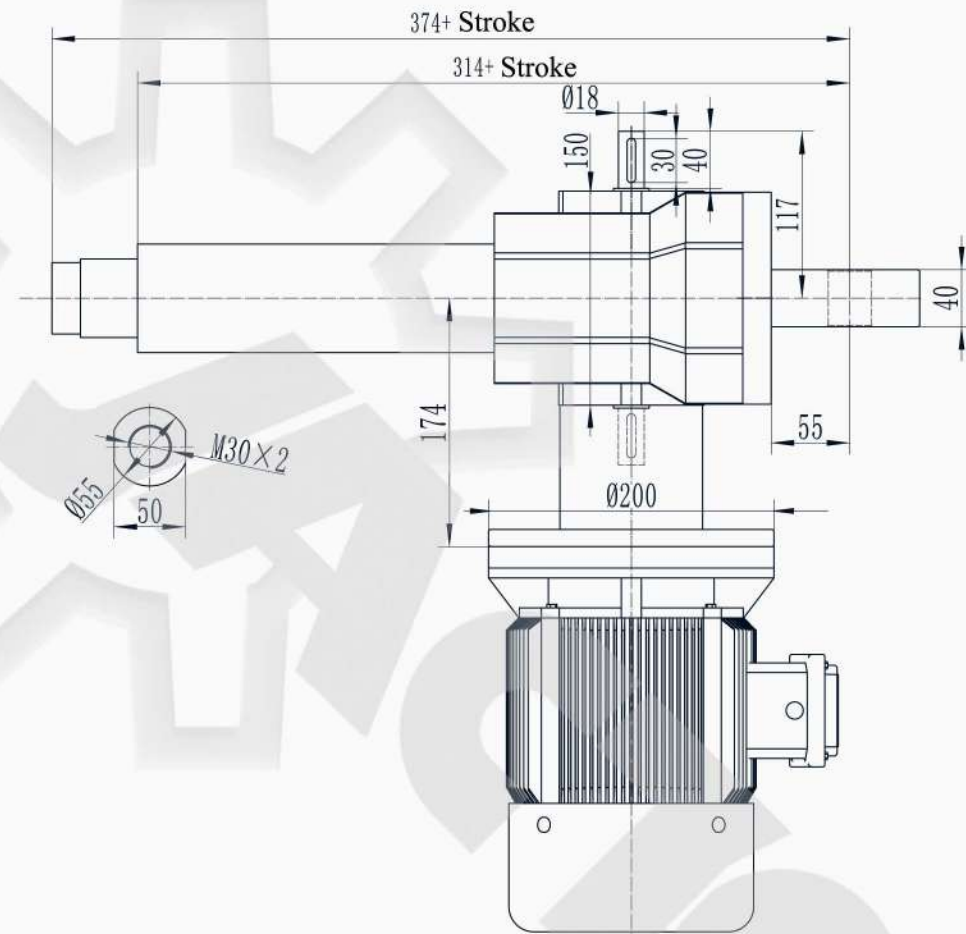

*. Dimensions are subject to change without notice